

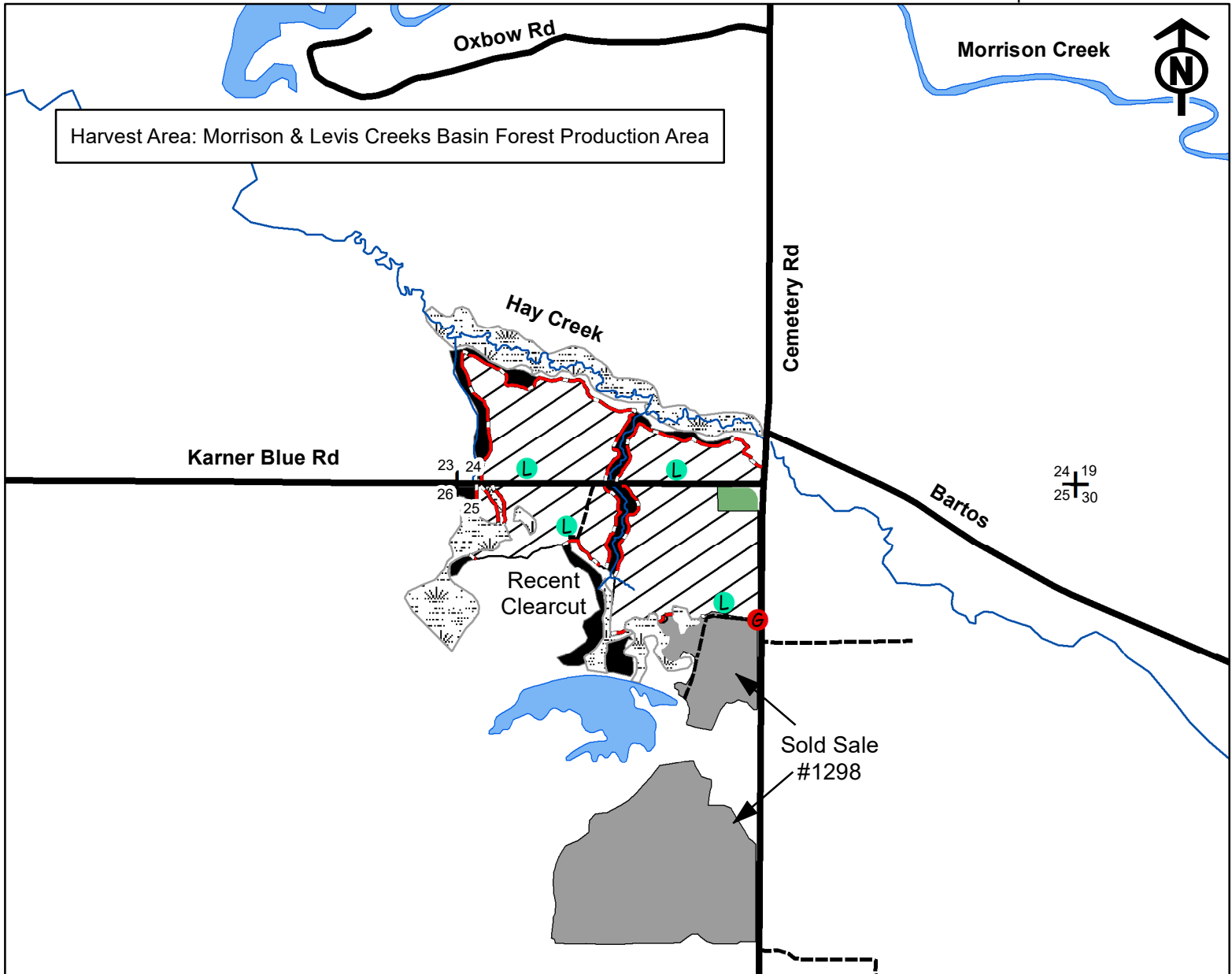









BLACK RIVER STATE FOREST
 TIMBER SALE MAP
 T22N-R3W Sec 24, 25
 TRACT # 12-23 Bus Stop Pine

Sale Size: 75 acres
 Map Scale: 1" = 1/4 mile



 75 Acres: Jack Pine Regeneration Harvest: Harvest all trees 2" DBH and larger EXCEPT trees marked with purple paint.

Approximately 10% of this sale is low ground and will require dry or frozen conditions. HRD treatment of the pine stumps required unless cut between Dec. 1 and March 31.

- | | | |
|--|---|--|
|  Stream |  Young Jack Pine |  Proposed Landing |
|  Red Paint Line |  Wetland |  Gate |
|  Double-Sided Red Paint Line |  Woods Road |  Section Corners |
|  13 Acres: RMZ & Green Tree Retention | | |

BRSF Tract 12-23
Bus Stop Pine
T22N R3W Sec 24, 25

Sale Size: 75 Acres
Contract Period: 3 Years

Estimated Volume

<u>Species</u>	<u>MBF Included in Volume</u>	<u>Cord Equivalent</u>	<u>Tons</u>
Jack Pine	0	590	1,250
White Pine	90	440	925
Red Pine	50	235	525
Oak*	0	110	300

*Includes approx. 44 tons of red maple and 3 tons of paper birch

Scaled Sale

Minimum Bid Value = \$30,340.00

Special Operating Requirements and Slash Disposal:

1. **Approximately 10% of the sale is on low ground and will require dry or frozen conditions.**
2. The sale boundaries are red paint lines, open wetland edges, old timber harvests, different cover type, woods road and town roads.
3. No biomass harvesting is allowed on this sale.
4. **All areas of the sale will require stump treatment for Heterobasidial Root Disease unless harvested between December 1 and March 31. Treatment must be performed by a Certified Pesticide Applicator. Treatment involves chemically treating all fresh-cut stumps of pines of merchantable size by applying either CELLU-TREAT (disodium octaborate tetrahydrate) or Rotstop C (biological fungicide). Treatment shall be made as soon as possible and no later than one day after harvest. A dye product shall be added to liquid solutions for inspection purposes.**
5. All pine products cut between March 1st and August 30 must be removed from the sale area within three weeks from time of cutting. Pine products cut during the remainder of the year must be removed before March 15th.
6. Slash must be evenly lopped/scattered within the sale boundary and shall be deposited a minimum of 10 feet from the mowed right-of-way of any highway, town road, or recreational trail. Slash within 50 feet of all town roads and recreational trails must lie within 2 feet of the ground. Do not bury seedlings or saplings with slash.

General Requirements:

1. All designated tree species must be cut and forwarded concurrently with the sale
2. All stumps shall be no higher than the stump diameter, or 10 inches, whichever is less.
3. Do not cut or knock down any dead or hollow trees. These are important wildlife habitat. Any that must be cut shall be left in big pieces on the forest floor.
4. Utilization: cut and use all designated trees with one or more 100" sticks to a 4" top diameter.
5. Notify the DNR forester (Nick Randall 715-586-8233) before you start the job, and each time you pull out or return to the job.
6. Any new roads and all landings must be approved by a DNR forester before operations begin.
7. Any berms removed during harvesting operations must be put back to the satisfaction of the DNR Forester.
8. Any trees cut or pushed over for roads or landings must be utilized or cleaned up to the DNR Forester's satisfaction.
9. Contact the Town of Komensky at 715-299-0093 prior to beginning logging operations. A permit is required for hauling heavy loads and equipment on all town roads year-round, and a driveway permit is needed for any new landings.
10. **Wisconsin's Best Management Practices for Invasive Species applies – contractor must clean equipment before entering and leaving the sale area! This involves brushing away all dirt and cleaning air intakes of debris.**