



June 22nd, 2023

Lincoln and Marathon Counties Timber Sale Information

Sealed bids will be received by mail or in person at the **Wausau Service Center 225051 Rib Mountain Drive Wausau, WI 54401**, up to Thursday, July 20th, 2023 at 1:00 pm and will be opened immediately thereafter for timber stumpage described in this prospectus. The public may attend in person or if wishing to attend virtually, please register prior to the meeting by calling:

Jeff Sorenson - 715-965-9228; jeff.sorenson@wisconsin.gov

Any questions about this bid opening can also be directed to Jeff Sorenson, as well.

This bid opening will be held for 4 tracts on the Prairie River Fishery Area, Mead Wildlife Area, and McMillan Wildlife Area.

Prairie River Fishery Area				Volume			
				Tons	MBF	Tons	
Sale Name	Tract #	Acres	Timber Type	4"	Logs	Whole Tree	Minimum Bid
Prairie Axe	3507-01-2023	36	Tamarack, MX hardwood, Mixed conifer, Aspen	1,455	NA	NA	\$10,174.00
Mead Wildlife Area				Volume			
				Tons	MBF	Tons	
Sale Name	Tract #	Acres	Timber Type	4"	Logs	Whole Tree	Minimum Bid
Huntmans Liar	3719-02-2023	51	MX hardwood, Aspen, Red oak	1,355	150	N.A.	\$27,302.50
Gravel Carp	3719-01-2023	109	Aspen, MX hardwood, Red Oak	2,800	110	N.A.	\$33,600.00
McMillan Wildlife Area				Volume			
				Tons	MBF	Tons	
Sale Name	Tract #	Acres	Timber Type	4"	Logs	Whole Tree	Minimum Bid
Fuzzy Mushroom	3718-01-2023	43	Aspen, MX hardwood, Ash, Red maple	1,040	26	N.A.	\$7,398.00

Contact Jeff Sorenson at (715-965-9228) for details on bid results. For tracts not sold on July 20th, 2023, sealed bids may be accepted by mail or in person until August 17th, 2023 at 1 pm.

BIDDING REQUIREMENTS

1. Bidding Procedure for Timber Sales
 - a. Bids will be made by species for each tract.
 - b. Estimated volumes and utilization specifications are listed on individual sale prospectus maps. Bid according to volumes listed on individual sale prospectus and/or maps.
 - c. The **high bidder** will be determined by the **greatest total bid** for each tract.
 - d. Bids will be opened in random order.
 - e. **Bidders in attendance (virtual)** can remove their bid from consideration before each individual tract is opened. Bidders must identify themselves by clearly stating their name,

address, and telephone number PRIOR to a bid being opened to withdraw their bid from consideration.

2. Bids may be made on one or more tracts.
3. Submit each bid in an **individual sealed envelope** marked "Bid for Timber Stumpage" with the timber sale name, and tract number on the outside. Wisconsin DNR Timber Sale Bid Forms must be used to make bids on DNR timber sales and is included with the individual sale prospectus
4. A per unit bid must be made on every item on a tract. No "zero" bids for any species or products will be accepted.
5. Winning bidders will be notified within 24 hours of bid opening and **must sign the timber sale contract and submit an acceptable performance bond within 6 weeks of the bid opening.** If the winning bidder fails to execute the contract and submit an acceptable performance bond, the bidder shall be required to forfeit to the department an amount equal to 10% of the total bid amount. Failure to forfeit the 10% penalty will result in the bidder being considered ineligible to bid on any state or GNA timber sales for a two-year period.
6. A **Performance Bond or Letter of Credit** is required before awarding of contract. The bond shall be fifteen percent (15%) of the total bid value or a minimum of \$1000.00, whichever is greater. The bond will be held intact by the Department of Natural Resources until the satisfactory completion of the timber sale contract. Performance bonds in a form of other than cash for these sales must expire no earlier than **1-year past contract expiration date.**
7. The Department of Natural Resources reserves the right to reject any and all bids.

SALES TAX CERTIFICATION

1. A [Sales and Use Tax Exemption Certificate](https://www.revenue.wi.gov/DORForms/s-211-inst.pdf) must be provided at the signing of the contract. This certificate is required to cover a contractor or individual reselling stumpage harvested for firewood/fuelwood and mills and manufacturing facilities. More information about the certificate can be found at <https://www.revenue.wi.gov/DORForms/s-211-inst.pdf>

UTILIZATION

1. See individual timber sales for utilization specifications.

SCALING AND PAYMENT

1. If eligible for deferred payment option, payment for timber removed from site must be made within 30 days after invoice.
2. If not eligible for deferred payment option, no wood will be hauled from the sale area until advanced payment is made.
3. If sold as a lump sum sale, payment in full must be made on entire sale, or by the cutting block, or by some other means as mutually agreed upon by Department of Natural Resources and contractor.
4. The mill scale ticket system will be used as the preferred method of sale administration. Other scaling systems may be used at the discretion of the Department of Natural Resources.
5. If a woods scale system is used, all cordwood or logs will be piled for scaling. Piles will be level and square with at least 10 cords per pile or 5 MBF. At least 20 cords or 10 MBF will be piled before a scale is requested. Scaling requests must be made at least one day in advance.
6. No refunds of stumpage payments will be made for un-removed wood, and wood left on the sale area at contract expiration shall revert to the seller.
7. Scribner Decimal C Log Rule shall be used for scaling logs. Conversion from MBF to cords or cords to MBF shall be 2.44 cords per MBF for softwoods and 2.2 cords per MBF for hardwoods.

8. Weight scale conversions will be at rates as specified in the Department of Natural Resources timber sale handbook listed below, unless the individual timber sale has specific mixed species pro-rates/conversions.

CORDWOOD WEIGHT CONVERSION FACTORS POUNDS PER CORD

<u>Species</u>	<u>Weight (lbs.)</u>	<u>Weight (tons)</u>	<u>Species</u>	<u>Weight (lbs.)</u>	<u>Weight (tons)</u>
Ash	4600	2.3	Jack pine	4250	2.125
Aspen	4500	2.25	Locust	5300	2.65
Balsam	4250	2.125	Mixed hardwood	4800	2.4
Balsam poplar	4900	2.45	Red oak	5500	2.75
Basswood	3850	1.925	Red pine	4500	2.25
Beech	5050	2.525	Soft maple	4550	2.275
Black Cherry	4300	2.15	Spruce	4000	2.0
Cedar	3150	1.575	Tamarack	4650	2.325
Cottonwood	4650	2.325	White birch	4800	2.4
Elm	5000	2.5	White oak	5850	2.925
Hard maple	5100	2.55	White pine	4200	2.1
Hemlock	4800	2.4	Yellow birch	5350	2.675
Hickory	5400	2.7			

CONTRACT PERIOD

1. All contracts offered during this bid opening will expire on June 30, 2026.

CONTRACT EXTENSIONS

Contract extensions will not be granted without justifiable reason. Justification will be determined by the Department of Natural Resources. Contract expiration dates are given on the individual timber sale. Contract extensions are not guaranteed. All extensions, if granted, will be for 1 year. Extension requests will be considered with the following conditions:

One and Two-year contracts

- 1st extension – 5% increase in stumpage rate
- 2nd extension – an additional 10% increase in stumpage rate

Three and Four-year Contracts

- 1st extension – 15% increase in stumpage rate (only 1 extension granted)

OTHER CONDITIONS

1. Wisconsin's Best Management Practices for Water Quality, Woody Biomass Harvesting Guidelines, and Best Management Practices for Invasive Species must be followed on all DNR timber sales. More information on these management guidelines can be found at the links found below.

Water Quality BMPs: <https://dnr.wi.gov/topic/ForestManagement/bmp.html>

Biomass: <https://councilonforestry.wi.gov/Pages/WoodyBiomass/Default.aspx>

Invasive BMPs: <https://councilonforestry.wi.gov/Pages/InvasiveSpecies/Forestry.aspx>

2. HRD/Oak Wilt requirements: See each sale for specific requirements.

3. See each sale for specific other sale special conditions.

Insurance

The “Contractor” (purchaser) shall provide the Department of Natural Resources with a Certificate of Insurance counter-signed by a Wisconsin Resident Agent, indicating that Worker’s Compensation Insurance coverage is provided for the duration of the contract prior to any performance under it. Contractor claiming exemption, independent status, the contractor/purchaser will be required to submit a signed, notarized affidavit that affirms their exempt status pursuant to the criteria listed in section 102.07(7)(b), of the Wisconsin Statutes.

Contract may contain other provisions. Contracts may not be assigned. A sample copy of the contract is available upon request.

NOTE: Prospectus maps for each of the timber sales are available online at <https://dnr.wisconsin.gov/topic/TimberSales>

*****TRAINING STANDARD*****

The Purchaser shall ensure that at least one in-woods person actively engaged in performance of this contract and responsible for the logging site complies with the Wisconsin Sustainable Forestry Initiative® (SFI®) Training Standard as adopted by the Wisconsin SFI Implementation Committee (SIC). Criteria for the standard can be found at the website https://www.fistausa.org/fista/SFI_Workshops.asp or by contacting the Forest Industry Safety & Training Alliance (FISTA). Purchaser agrees to provide documentation to Seller that the training has been attained prior to initiating sale.

FOREST CERTIFICATION: These lands are 3rd party certified.

Prairie Axe
Tract # 3507-01-2023
State of Wisconsin
Prairie River Fishery Area

Forester Contact Information:
Zachary Hylinski / Timothy Allen
101 Eagle Dr. Merrill, WI 54452
Zachary.hylinski@wisconsin.gov - 715-921-5611
Timothyc.allen@wisconsin.gov – 715-965-8547

Legal Description: Part of SENE Section 31 and part of NWNW, NENW, and SWNW Section 32 of T33N R8E - Town of Russell, Lincoln County (see attached map for location and layout of harvest areas)

Species	Units	Volumes*
Tamarack ¹	Tons	450
Red maple ²	Tons	260
Spruce ³	Tons	240
Aspen	Tons	210
Balsam fir	Tons	150
Red Pine ⁴	Tons	95
White pine ⁵	Tons	50
Total		1,455

*All volumes use DNR standard weight conversions

¹ Includes approx. 20 MBF tamarack

² Red maple volume is approx. 65% red maple, 30% ash, 5% cherry and includes approx. 5 MBF red maple

³ Includes approx. 10 MBF spruce

⁴ Includes approx. 8 MBF red pine

⁵ Includes approx. 3 MBF white pine

Sale method: Mill scale

Contract length and end date: Three years or June 30, 2026

Minimum advertised value: \$ 10,174

Acres: 36

Cutting Specifications

- Unit 1 – Aspen coppice and conifer seedtree regeneration harvest area - 28 acres: Cut all stems greater than 1 inch (DBH) except for oak, white cedar, and green-marked trees. Operating in alder pockets is prohibited; cutting specifications do not apply to tag alder-dominated pockets. Town roads and red paint lines represent the cutting boundaries of this unit. Do not cut within yellow-lined reserve tree areas.
- Unit 2 – Pine thinning area – 8 acres: Cut all orange-marked trees, balsam fir, spruce, tamarack, aspen, and red maple stems greater than 4 inches (DBH). Town roads, parking area, young aspen, and red/blue paint lines represent the cutting boundaries of this unit. Only shortwood skidding allowed in Unit 2.
- All harvested pieces with at least a 4 inch top diameter must be utilized.
- Whole tree harvesting is NOT permitted on this sale.

Operational Considerations-

- Harvesting operations must occur only during sufficiently dry or frozen-ground conditions. Operations will be suspended during wet periods when soil is susceptible to rutting and excessive compaction.
- Contractor must adhere to Timber Sale Contract rutting standards and Wisconsin Best Management Practices for Water Quality.

- New roads and landings must be approved by a state forester prior to building. Roads and landings must be restored to pre-sale condition.
- Equipment operations outside of harvest boundaries are prohibited; trees felled over harvest boundary lines must be pulled back into the sale area before being limbed and topped. Trees felled into field areas or wildlife openings must also be pulled back into the sale area before being limbed and topped.
- Minimize damage to green-marked and other designated leave trees.
- Do not cut standing dead trees, unless leaving them represents a hazard to operator safety.
- Do not cut any trees marked with Green, Red, Blue, or Yellow paint.
- Contractor must properly disperse slash throughout the sale. Slash may not exceed 3 feet in height. Slash must be kept off landings, parking areas, town and woods roads, and private property. Stump heights must be no greater than the diameter of the stump or 12 inches, whichever is less.
- Harvesting equipment must be power washed and be free and clear of debris before entering sale.
- Between May 1st and August 31st, all cut pine and spruce must be hauled within 2 weeks.
- **SPECIAL CONDITIONS:** All Pine, Spruce and Balsam will require HRD (heterbasidion root disease) prevention treatment by the contractor if cut between April 1st and November 30th.
 1. The contractor shall purchase and apply an approved fungicide to all cut Pine, Spruce and Balsam stumps and horizontal wound surfaces.
 2. Pesticide applicators must be certified/licensed by DATCP for this treatment.
 3. All stumps shall be treated by the end of each day.
 4. All stumps shall be left clear of logging slash to allow for the application and inspection of the approved fungicide.
 5. A marker dye shall be added to the solution to monitor application coverage.
- **Modifications to HRD treatment:**
 1. Prolonged, unusually warm weather during the winter period (December 1 - March 31), treatment may be recommended.
 2. Prolonged, unusually cold weather outside the winter period (outside of December 1 - March 31), treatment may not be necessary.
 3. Deep snow cover (at least 12 inches) outside of the winter period (outside of December 1 - March 31), treatment may not be necessary

Timber Sale Name: Prairie Axe
Tract #: 3507-01-2023
Property Owner: State of Wisconsin
Name of Property: Prairie River Fishery Area

Legal Descriptions: Part of SENE Section 31
and part of NWNW, NENW, and SWNW Section 32
of T33N R8E - Town of Russell, Lincoln County

Volumes*

Species	Tonnage
Tamarack	450 tons
Red maple	260 tons
Spruce	240 tons
Aspen	210 tons
Balsam fir	150 tons
Red pine	95 tons
White pine	50 tons
Totals	1455 tons

* See prospectus for additional details

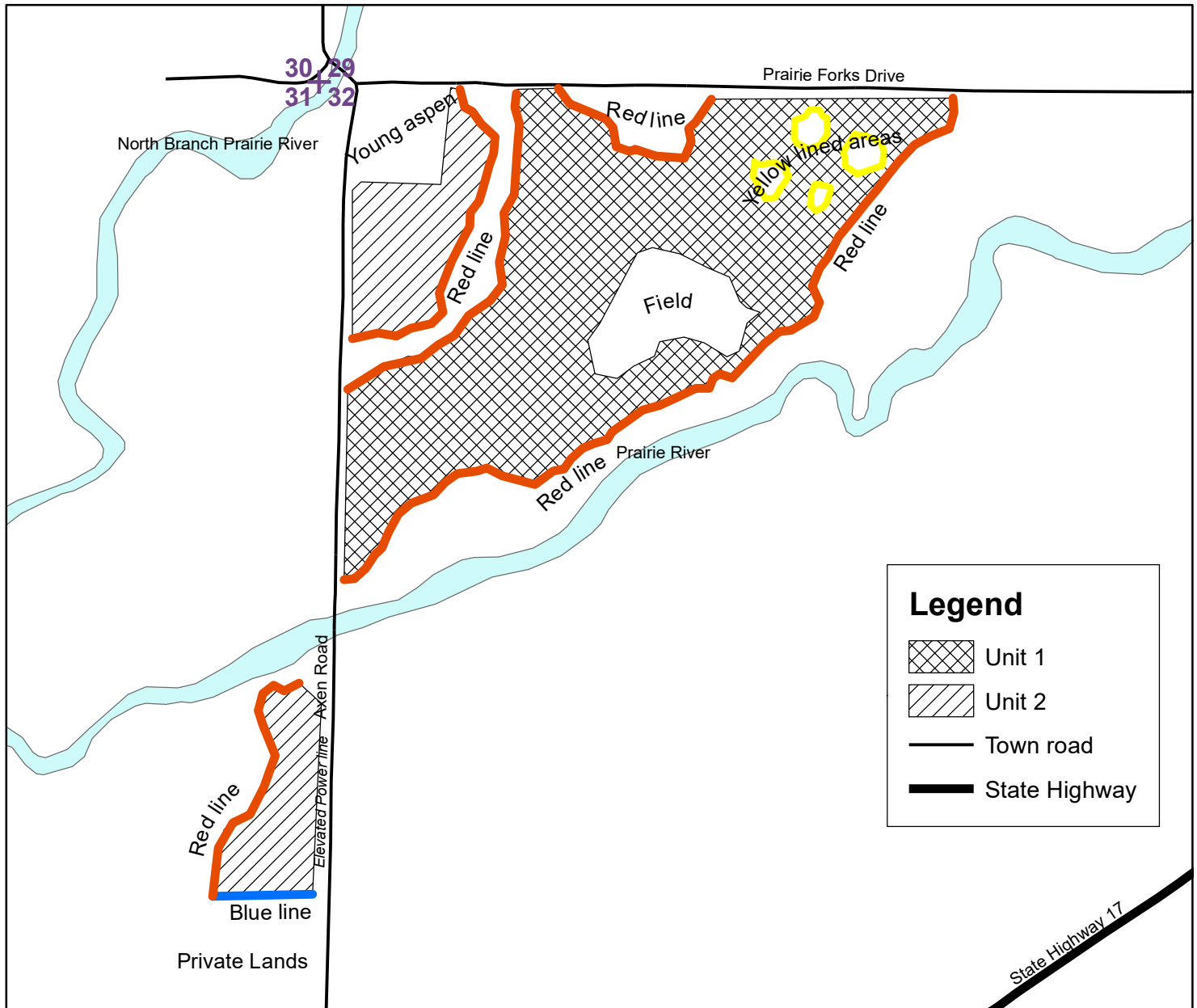

Unit 1 - Regeneration harvest - aspen coppice / conifer seedtree.

Harvest all stems greater than 1 inch (DBH) except oak, cedar, & green-marked trees.

28 acres (includes 1 acre of reserve trees)

Unit 2 - Red pine thinning. Harvest all orange-marked pine and non-pine stems greater than 4 inches (DBH). 8 acres.

Contract Ending Date: June 30, 2026

Sale Method: Mill scale

This map is not a survey of the actual boundary of any property this map depicts

Mapped by: Timothy Allen

0 165 330 660 Feet

Notice: Completion of this form is mandatory. The Department will not recognize your bid unless you complete and submit this form. Personal information collected will be used for program administration and may be provided to requesters as required by Wisconsin's Public Records law [ss. 19.31-19.39, Wis. Stats.].

Date

Bidder Name

Street Address	City	State	ZIP Code
----------------	------	-------	----------

Property Name (if any) Prairie River Fishery Area	Timber Sale Name Prairie Axe	Tract Number 3507-01-2023
--	---------------------------------	------------------------------

Date and Hour of Bid Opening 7/20/2023 1PM	Minimum Acceptable Bid (optional) \$10,174.00
---	--

Species-All bids including Lump Sum bids must be by species	Utilization Specifications (4 inch/Whole Tree/Logs)	Estimated Volume	Volume Units (tons/cords/mbf)	Price Bid Per Unit	Total Bid Value on Estimated Volume
Tamarack	4 inch top	450	tons		
Red maple	4 inch top	260	tons		
Spruce	4 inch top	240	tons		
Aspen	4 inch top	210	tons		
Balsam fir	4 inch top	150	tons		
Red pine	4 inch top	95	tons		
White pine	4 inch top	50	tons		

The award shall be based on this TOTAL BID AMOUNT:

Performance Bond Will be in the form of: (select one)

Personal Check
 Assurance Bond
 Certified Check/Money Order
 Certificate of Deposit
 Irrevocable Letter of Credit
 Assignment of Savings Account

I understand that any or all bids may be rejected and that consideration and awarding of a contract will be based upon my past performance and ability to complete contracts. **I also understand that if I am the winning bidder, I have 6 weeks from the date of the bid opening to submit an acceptable performance bond. I also understand that if I am awarded the contract and fail to execute it or work under it, I will be required to forfeit to the Department an amount equal to 10% of my total bid amount.** Failure to forfeit the 10% penalty will result in being considered ineligible to bid on any state timber sales for a two-year duration. In the event the highest bidder can not or will not sign the contract, the award may be made to the next highest qualified bid.

By checking this box, I certify that I hold a Wisconsin Master Logger Certification.

Notice: I understand:

Utilization specifications and estimated volumes are listed in the prospectus which is available upon request from the Department.

A copy of the standard timber sales contract which must be entered into is available upon request from the Department.

Signature of Bidder
Bidder's Name (Please Print or Type)
Phone Number (include area code)
Email Address

Huntmans Lair Sale
3719-02-2023
Wisconsin DNR
Mead Wildlife Area

Forester Contact Information:
 Nicholas Hovda
 225051 Rib Mountain Drive
 Wausau, WI 54401
Nicholas.Hovda@wisconsin.gov
 715-297-0211

Legal Description: SENW SWNE NESE NWSE NESW
 Section 22 T26N R5E Town of Green Valley, Marathon County

see attached map for location and layout of harvest area(s)

Volume Estimates

Species	Pulp/Bolts		Logs		Minimum Acceptable Value:
Mixed HWD ¹	875	Tons	10	MBF	\$27,302.50
Aspen	430	Tons	N/A		Scaling Method: Mill Scale
Red Oak	50	Tons	25	MBF	Contract Ending Date: June 30, 2026
Ash	N/A		45	MBF	Sale Area: 51 Acres
Red Maple	N/A		40	MBF	
Sugar Maple	N/A		20	MBF	
Basswood	N/A		10	MBF	
Totals	1355	Tons	150	MBF	

¹Mixed Hardwood Pulp is comprised 42% of red maple, 25% of white ash, 15% of sugar maple, 5% of basswood, 5% of yellow birch, and 7% mix of black cherry, elm, white birch, and bitternut hickory. Mixed Hardwood Sawlogs consist of 50% bitternut hickory, 25 % elm, 20% white birch, and 5% yellow birch. Mixed Hardwood wt. conv. 2.40 tons/cord. Aspen wt. conv. 2.25 tons/cord. Ash sawlogs consist of 100% white ash.

Access:

- Access to this timber sale is found a quarter mile west of the dead-end of Ancestor Lane. A field road starting at the DNR Parking Lot will lead to the west entrance of the timber sale. From there, a woods road bisects the timber sale from west to east. A snowmobile trail may be impacted by the timber sale. The local snowmobile club must be contacted prior to sale activity. No logging debris or equipment shall be left on the snowmobile trail. Plowing the trail must be done in a way to leave snow on the trail.

Cutting Specifications:

- **Sale Area (51 acres):** Cut all trees greater than 2" in diameter within the red paint boundaries except for trees marked in green bands. Leave all conifer species.
- Cutting must be concurrent for all species to be harvested. Non-merchantable trees must be cut concurrent with merchantable trees. Whole tree harvesting will not be permitted in this sale.
- Sawlog top diameter minimum of 10 inches. Pulpwood top diameter minimum of 4 inches.

Operational Considerations:

- Roads and landings utilized during the timber sale must be returned to original condition.
- Harvesting during frozen ground conditions only. No harvesting activity between March 4th through November 15th due to NHI and oak wilt concerns.
- New landings and roads must be approved by the DNR Forester. Don't cut green marked trees.
- No equipment entry or harvesting activity of any kind allowed within wetlands. No slash shall be left within the wetland filter strip (flowage edge and red paint boundary).
- Equipment must be clean and free of debris prior to entering the sale.
- Prompt and proper treatment of slash where required. It is the responsibility of the timber contractor to spread all slash evenly throughout the sale down to 2 ft. No slash on trails, landings, or private property.
- This is a 3-year contract ending on June 30, 2026.

Huntmans Lair Sale

Tract #: 3719-02-2023

Wisconsin DNR

Mead Wildlife Area

Legal Description:
 SENW SWNE NESE NWSE NESW
 Section 22 T26N R5E Town of Green Valley, Marathon County (51 Acres)

Volumes

Species	Pulp (Tons)	Sawlogs (MBF)
Mixed Hardwood	875	10
Aspen	430	N/A
Red Oak	50	25
Ash	N/A	45
Red Maple	N/A	40
Sugar Maple	N/A	20
Basswood	N/A	10

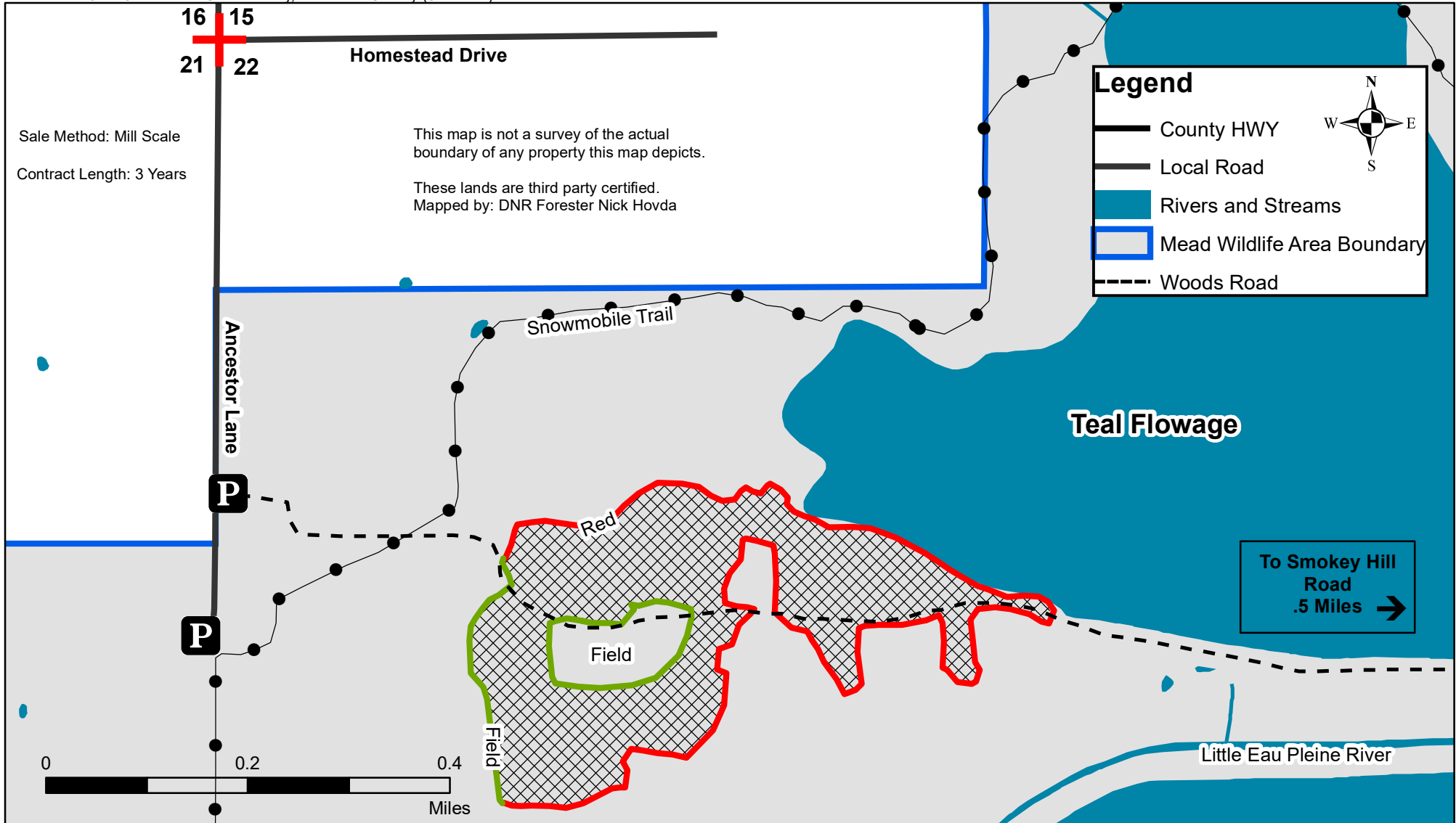

- Sale Area (51 Acres): Cut all trees greater than 2" in diameter within the red paint boundaries except for trees marked in green bands. Leave all conifer species.



Notice: Completion of this form is mandatory. The Department will not recognize your bid unless you complete and submit this form. Personal information collected will be used for program administration and may be provided to requesters as required by Wisconsin's Public Records law [ss. 19.31-19.39, Wis. Stats.].

Date

Bidder Name

Street Address	City	State	ZIP Code
----------------	------	-------	----------

Property Name (if any) Mead Wildlife Area	Timber Sale Name Huntmans Lair	Tract Number 3719-02-2023
--	-----------------------------------	------------------------------

Date and Hour of Bid Opening July 20, 2023 at 1:00pm	Minimum Acceptable Bid (optional) \$27,302.50
---	--

Species-All bids including Lump Sum bids must be by species	Utilization Specifications (4 inch/Whole Tree/Logs)	Estimated Volume	Volume Units (tons/cords/mbf)	Price Bid Per Unit	Total Bid Value on Estimated Volume
Mixed Hardwoods	4 inch	875	TONS		
Aspen	4 inch	430	TONS		
Red Oak	4 inch	50	TONS		
Mixed Hardwoods	Logs	10	MBF		
Red Oak	Logs	25	MBF		
Ash	Logs	45	MBF		
Red Maple	Logs	40	MBF		
Sugar Maple	Logs	20	MBF		
Basswood	Logs	10	MBF		

The award shall be based on this TOTAL BID AMOUNT:

Performance Bond

Will be in the form of: (select one)

- | | |
|--|---|
| <input type="radio"/> Personal Check | <input type="radio"/> Assurance Bond |
| <input type="radio"/> Certified Check/Money Order | <input type="radio"/> Certificate of Deposit |
| <input type="radio"/> Irrevocable Letter of Credit | <input type="radio"/> Assignment of Savings Account |

I understand that any or all bids may be rejected and that consideration and awarding of a contract will be based upon my past performance and ability to complete contracts. **I also understand that if I am the winning bidder, I have 6 weeks from the date of the bid opening to submit an acceptable performance bond. I also understand that if I am awarded the contract and fail to execute it or work under it, I will be required to forfeit to the Department an amount equal to 10% of my total bid amount.** Failure to forfeit the 10% penalty will result in being considered ineligible to bid on any state timber sales for a two-year duration. In the event the highest bidder can not or will not sign the contract, the award may be made to the next highest qualified bid.

By checking this box, I certify that I hold a Wisconsin Master Logger Certification.

Notice: I understand:

Utilization specifications and estimated volumes are listed in the prospectus which is available upon request from the Department.

A copy of the standard timber sales contract which must be entered into is available upon request from the Department.

Signature of Bidder
Bidder's Name (Please Print or Type)
Phone Number (include area code)
Email Address

Gravel Carp Sale
3719-01-2023
Wisconsin DNR
Mead Wildlife Area

Forester Contact Information:
 Nicholas Hovda
 225051 Rib Mountain Drive
 Wausau, WI 54401
Nicholas.Hovda@wisconsin.gov
 715-297-0211

Legal Description: NESE, SESE, SWSE, NWSE, SWNE Sec. 14 T26N R5E Town of Green Valley, Marathon County
 NESE, SESE Section 15 T26N R5E, Town of Green Valley, Marathon County

see attached map for location and layout of harvest area(s)

Volume Estimates

Species	Pulp/Bolts		Logs		Minimum Acceptable Value:
Aspen	1850	Tons	N/A		\$33,600.00
Mixed HWD ¹	650	Tons	15	MBF	Scaling Method: Mill Scale
Red Oak	300	Tons	50	MBF	Contract Ending Date: June 30, 2026
Red Maple	N/A		30	MBF	Sale Area: 109 Acres
Ash	N/A		15	MBF	
Totals	2800	Tons	110	MBF	

¹ Mixed Hardwood pulp consists of 55% red maple, 22% of white ash, 16% of sugar maple, and 7% of basswood, white birch, and elm. Mixed Hardwood Sawlogs consists of 50% sugar maple, 25% basswood, and 25% elm. Mixed Hardwood wt. conv. 2.40 tons/cord. Aspen wt. conv. 2.25 tons/cord. Ash Sawlogs consist of 100% white ash.

Access: Access can be found at multiple locations. To access the northeast portion of the timber sale, a DNR parking lot is located a quarter mile west of the CTY C and CTY S intersection. To access the southeast portion of the timber sale, a DNR parking lot is located a half mile south of the CTY C and CTY S intersection. To access the west portion of the timber sale, Old Settler Lane can be used with private access permission, or via woods road from the southeast DNR parking lot. A snowmobile trail borders the south end of the timber sale. The local snowmobile club must be contacted prior to sale activity. No logging debris or equipment shall be left on the snowmobile trail. Plowing the trail must be done in a way to leave snow on the trail.

Cutting Specifications

- **Sale Area (109 acres):** Cut all trees greater than 2" in diameter within the red and blue paint boundaries except for trees marked in green bands. Leave all conifer species.
- Cutting must be concurrent for all species to be harvested. Non-merchantable trees must be cut concurrent with merchantable trees. Whole tree harvesting will not be permitted in this sale.
- Sawlog top diameter minimum of 10 inches. Pulpwood top diameter minimum of 4 inches.

Operational Considerations:

- Roads and landings utilized during the timber sale must be returned to original condition.
- Harvesting during frozen ground conditions only. No harvesting activity between March 4th through November 15th due to NHI and oak wilt concerns.
- New landings and roads must be approved by the DNR Forester.
- No equipment entry or harvesting activity of any kind allowed within the RMZ. No slash shall be left within the RMZ. The RMZ is designated by purple paint.
- Do not cut any trees marked in green, purple or blue paint.
- Equipment must be clean and free of debris prior to entering the sale.
- Prompt and proper treatment of slash where required. It is the responsibility of the timber contractor to spread all slash evenly throughout the sale down to 2 ft. No slash on trails, landings, or private property.
- This is a 3-year contract ending on June 30, 2026.

Gravel Carp Sale

Tract #: 3719-01-2023

Wisconsin DNR

Mead Wildlife Area

Legal Description:
 NESE, SESE, SWSE, NWSE, SWNE Section 14 T26N R5E, Twn. of Green Valley Marathon County
 NESE, SESE Section 15 T26N R5E, Twn. of Green Valley Marathon County (109 Acres)

Volumes

Species	Pulp (Tons)	Sawlogs (MBF)
Aspen	1850	N/A
Mixed Hardwood	650	15
Oak	300	50
Red Maple	N/A	30
Ash	N/A	15

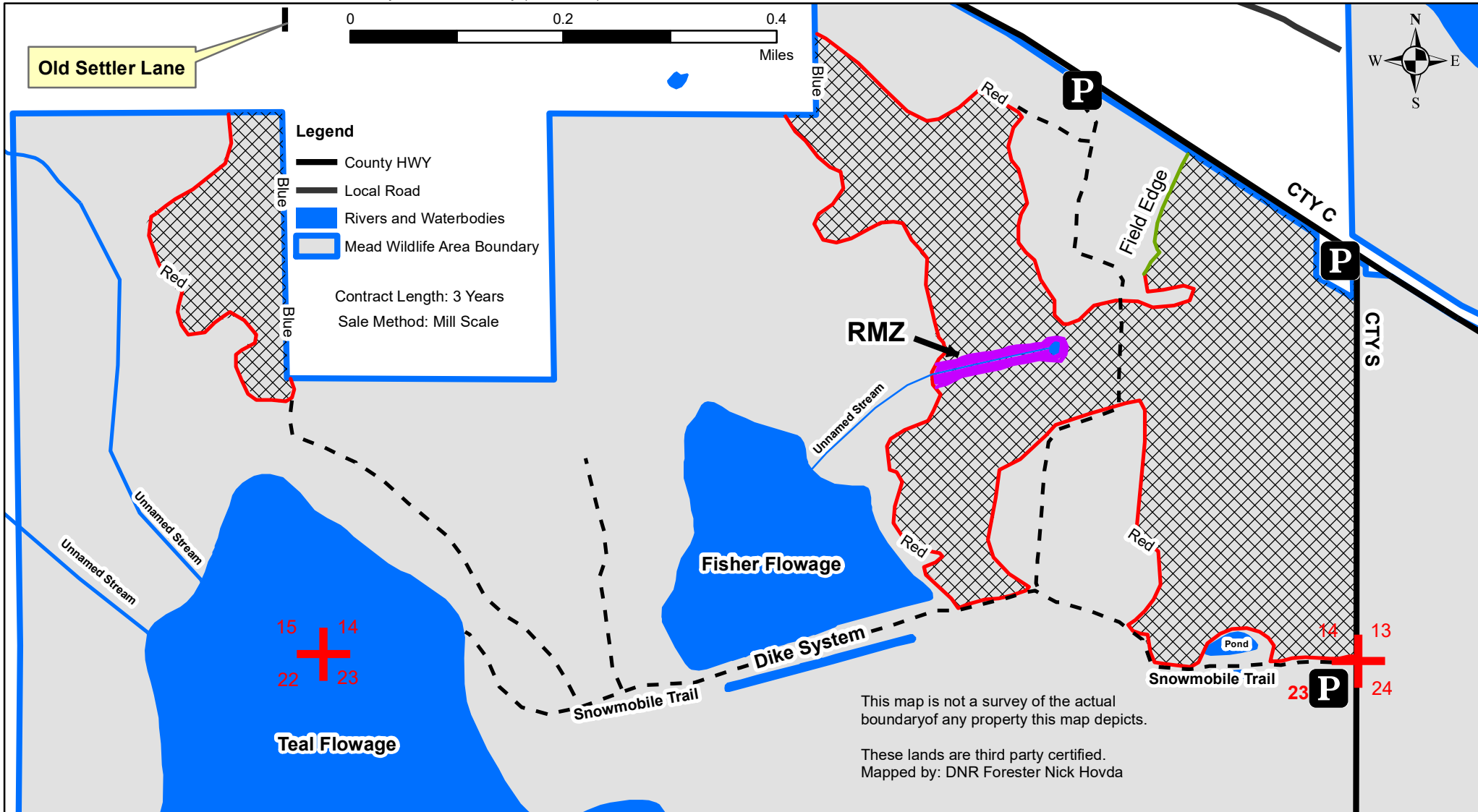

This map is not a survey of the actual boundary of any property this map depicts.
 These lands are third party certified.
 Mapped by: DNR Forester Nick Hovda

 - Sale Area (109 Acres): Cut all trees greater than 2" in diameter within the red paint boundaries except for trees marked in green bands. Leave all conifer species. Purple "V" indicate the RMZ. No slash, equipment entry, or harvesting activity of any kind allowed within the RMZ. All purple trees shall be left standing.



Notice: Completion of this form is mandatory. The Department will not recognize your bid unless you complete and submit this form. Personal information collected will be used for program administration and may be provided to requesters as required by Wisconsin's Public Records law [ss. 19.31-19.39, Wis. Stats.].

Date

Bidder Name

Street Address	City	State	ZIP Code
----------------	------	-------	----------

Property Name (if any) Mead Wildlife Area	Timber Sale Name Gravel Carp	Tract Number 3719-01-2023
--	---------------------------------	------------------------------

Date and Hour of Bid Opening July 20, 2023 at 1:00pm	Minimum Acceptable Bid (optional) \$33,600.00
---	--

Species-All bids including Lump Sum bids must be by species	Utilization Specifications (4 inch/Whole Tree/Logs)	Estimated Volume	Volume Units (tons/cords/mbf)	Price Bid Per Unit	Total Bid Value on Estimated Volume
Aspen	4 inch	1,850	TONS		
Mixed Hardwoods	4 inch	650	TONS		
Red Oak	4 inch	300	TONS		
Mixed Hardwoods	Logs	15	MBF		
Red Oak	Logs	50	MBF		
Red Maple	Logs	30	MBF		
Ash	Logs	15	MBF		

The award shall be based on this TOTAL BID AMOUNT:

Performance Bond	Will be in the form of: (select one)
<input type="radio"/> Personal Check	<input type="radio"/> Assurance Bond
<input type="radio"/> Certified Check/Money Order	<input type="radio"/> Certificate of Deposit
<input type="radio"/> Irrevocable Letter of Credit	<input type="radio"/> Assignment of Savings Account

I understand that any or all bids may be rejected and that consideration and awarding of a contract will be based upon my past performance and ability to complete contracts. **I also understand that if I am the winning bidder, I have 6 weeks from the date of the bid opening to submit an acceptable performance bond. I also understand that if I am awarded the contract and fail to execute it or work under it, I will be required to forfeit to the Department an amount equal to 10% of my total bid amount.** Failure to forfeit the 10% penalty will result in being considered ineligible to bid on any state timber sales for a two-year duration. In the event the highest bidder can not or will not sign the contract, the award may be made to the next highest qualified bid.

By checking this box, I certify that I hold a Wisconsin Master Logger Certification.

Notice: I understand:

Utilization specifications and estimated volumes are listed in the prospectus which is available upon request from the Department.

A copy of the standard timber sales contract which must be entered into is available upon request from the Department.

Signature of Bidder
Bidder's Name (Please Print or Type)
Phone Number (include area code)
Email Address

**Fuzzy Mushroom
3718-01-2023
Wisconsin DNR
McMillan Wildlife Area**

Forester Contact Information:
Nicholas Hovda
225051 Rib Mountain Drive
Wausau, WI 54401
Nicholas.Hovda@wisconsin.gov
715-297-0211

Legal Description: NESE SESE Section 14 T26N R2E
Town of Spencer, Marathon County
see attached map for location and layout of harvest area(s)

Volume Estimates

Species	Pulp/Bolts		Logs		Minimum Acceptable Value:
Aspen	850	Tons	N/A		\$7,398.00
Mixed HWD ¹	190	Tons	1	MBF	Scaling Method: Mill Scale
Ash	N/A		15	MBF	Contract Ending Date: June 30, 2026
Red Maple	N/A		10	MBF	Sale Area: 43 Acres
Totals	1040	Tons	26	MBF	

¹Mixed Hardwood Pulp is comprised 76% of black ash, 21% of red maple, and 3% of elm and white birch. Mixed Hardwood wt. conv. 2.40 tons/cord. Aspen wt. conv. 2.25 tons/cord.

Access:

- This timber sale is located at the northwest corner of the Frey Ave & Karau Ave intersection. A DNR Parking lot is found on near the northeast corner of the timber sale as well as a DNR parking lot along Karau Ave located near the southwest corner to use as access. A snowmobile trail may be impacted by the timber sale. The local snowmobile club must be contacted prior to sale activity. No logging debris or equipment shall be left on the snowmobile trail. Plowing the trail must be done in a way to leave snow on the trail.

Cutting Specifications

- **Sale Area (43 acres):** Cut all trees greater than 2" in diameter within the red paint boundaries and roads except for trees marked in green bands. Leave all conifer species.
- Cutting must be concurrent for all species to be harvested. Non-merchantable trees must be cut concurrent with merchantable trees. Whole tree harvesting will not be permitted in this sale.
- Sawlog top diameter minimum of 10 inches. Pulpwood top diameter minimum of 4 inches.

Operational Considerations:

- Roads and landings utilized during the timber sale must be returned to original condition.
- Harvesting during frozen ground conditions only.
- New landings and roads must be approved by the DNR Forester.
- No equipment entry or harvesting activity of any kind allowed within wetlands. No slash shall be left within the wetland filter strip or wetlands.
- Do not cut any trees marked in green paint.
- Equipment must be clean and free of debris prior to entering the sale.
- Prompt and proper treatment of slash where required. It is the responsibility of the timber contractor to spread all slash evenly throughout the sale down to 2 ft. No slash on trails, landings, or private property.
- This is a 3-year contract ending on June 30, 2026.

Fuzzy Mushroom Sale

Tract #: 3718-01-2023

Wisconsin DNR

McMillan Wildlife Area

Legal Description:
 NESE SESE Section 14 T26N R2E
 Town of Spencer, Marathon County (43 acres)

VOLUMES

Species	Pulp (Tons)	Sawlogs (MBF)
Aspen	850	N/A
Mixed Hardwood	190	1
Ash	N/A	15
Red Maple	N/A	10

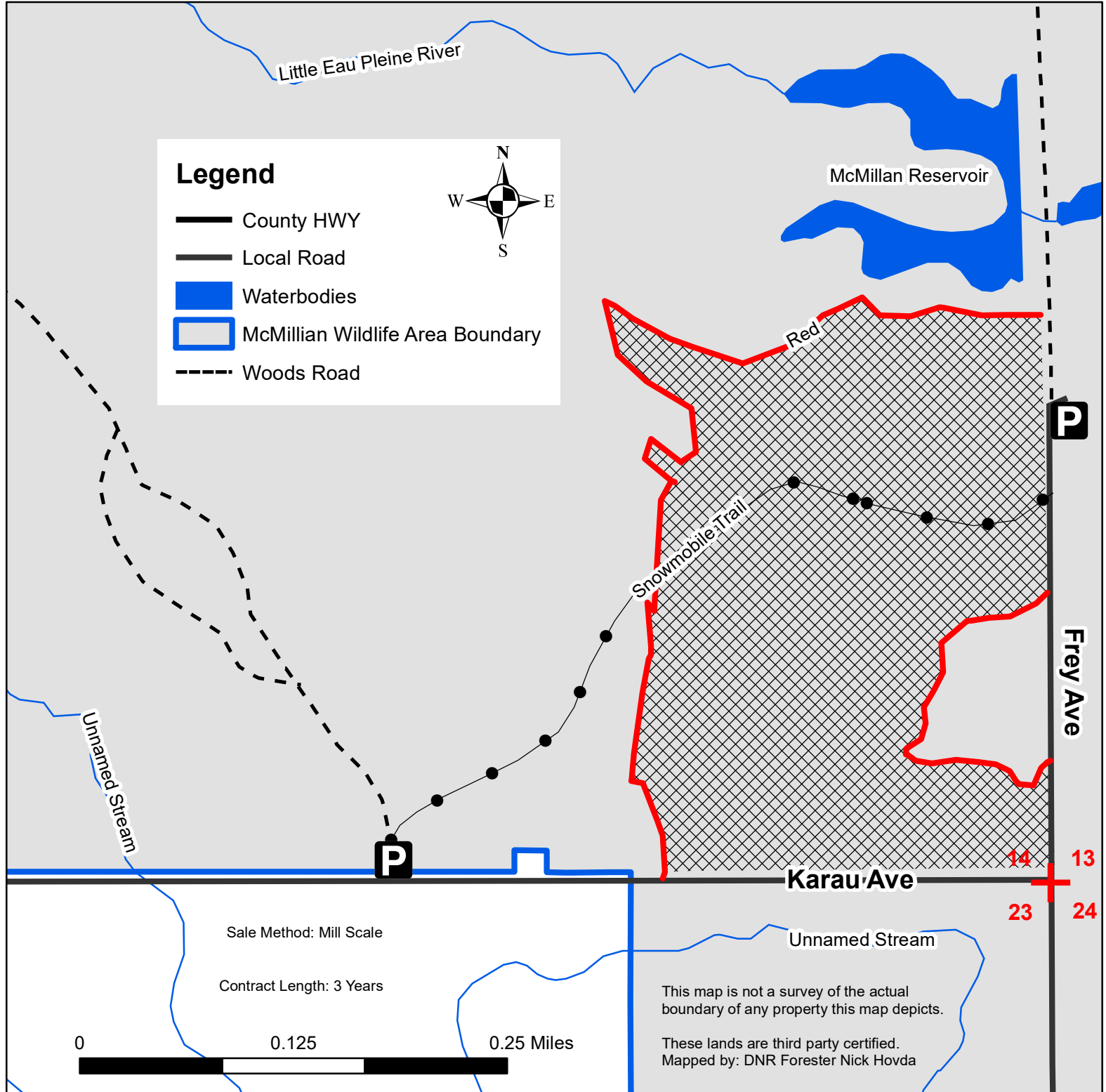

- Sale Area (43 Acres): Cut all trees greater than 2" in diameter within the red paint boundaries and roads except for trees marked in green bands. Leave all conifer species.



Notice: Completion of this form is mandatory. The Department will not recognize your bid unless you complete and submit this form. Personal information collected will be used for program administration and may be provided to requesters as required by Wisconsin's Public Records law [ss. 19.31-19.39, Wis. Stats.].

Date

Bidder Name			
-------------	--	--	--

Street Address	City	State	ZIP Code
----------------	------	-------	----------

Property Name (if any) McMillan Wildlife Area	Timber Sale Name Fuzzy Mushroom	Tract Number 3718-01-2023
--	------------------------------------	------------------------------

Date and Hour of Bid Opening July 20, 2023 at 1:00pm	Minimum Acceptable Bid (optional) \$7,398.00
---	---

Species-All bids including Lump Sum bids must be by species	Utilization Specifications (4 inch/Whole Tree/Logs)	Estimated Volume	Volume Units (tons/cords/mbf)	Price Bid Per Unit	Total Bid Value on Estimated Volume
Aspen	4 inch	850	TONS		
Mixed Hardwood	4 inch	190	TONS		
Ash	Logs	15	MBF		
Red Maple	Logs	10	MBF		
Mixed Hardwood	Logs	1	MBF		

The award shall be based on this TOTAL BID AMOUNT:

Performance Bond Will be in the form of: (select one)

Personal Check
 Assurance Bond
 Certified Check/Money Order
 Certificate of Deposit
 Irrevocable Letter of Credit
 Assignment of Savings Account

I understand that any or all bids may be rejected and that consideration and awarding of a contract will be based upon my past performance and ability to complete contracts. **I also understand that if I am the winning bidder, I have 6 weeks from the date of the bid opening to submit an acceptable performance bond. I also understand that if I am awarded the contract and fail to execute it or work under it, I will be required to forfeit to the Department an amount equal to 10% of my total bid amount.** Failure to forfeit the 10% penalty will result in being considered ineligible to bid on any state timber sales for a two-year duration. In the event the highest bidder can not or will not sign the contract, the award may be made to the next highest qualified bid.

By checking this box, I certify that I hold a Wisconsin Master Logger Certification.

Notice: I understand:

Utilization specifications and estimated volumes are listed in the prospectus which is available upon request from the Department.

A copy of the standard timber sales contract which must be entered into is available upon request from the Department.

Signature of Bidder
Bidder's Name (Please Print or Type)
Phone Number (include area code)
Email Address