

State of Wisconsin
DEPARTMENT OF NATURAL RESOURCES
620 W Layman Drive
Mellen, WI 54891
920-604-5631

Avery Jehnke, Forester
Telephone 920-604-5631
Averya.jehnke@wisconsin.gov



October 31, 2023

Subject: Direct Timber Sale on State Lands in Ashland County

To Interested Contractors:

The following timber sale is available for direct purchase by a qualified contractor:

Tract 1-22
White River Wildlife Area
Town of Gingles, Ashland County, Wisconsin

Please see attached map and prospectus

For more information about this timber sale, please reach out to the Forester administering the sale:

Avery Jehnke
920-604-5631
Averya.jehnke@wisconsin.gov
620 West Layman Drive
Mellen, WI 54891

WISCONSIN DNR TIMBER SALE
 "SPRUCE WIPEOUT" TRACT 1-22
 40 ACRES CLEARCUT WITH RESERVES
 8 ACRES RESERVE

White River Wildlife Area
 NWSE, NESE, SENE Section 35 T47N R4W
 Town of Gingles, Ashland County
 DNR Contact Avery Jehnke
 920-604-5631 averya.jehnke@wi.gov

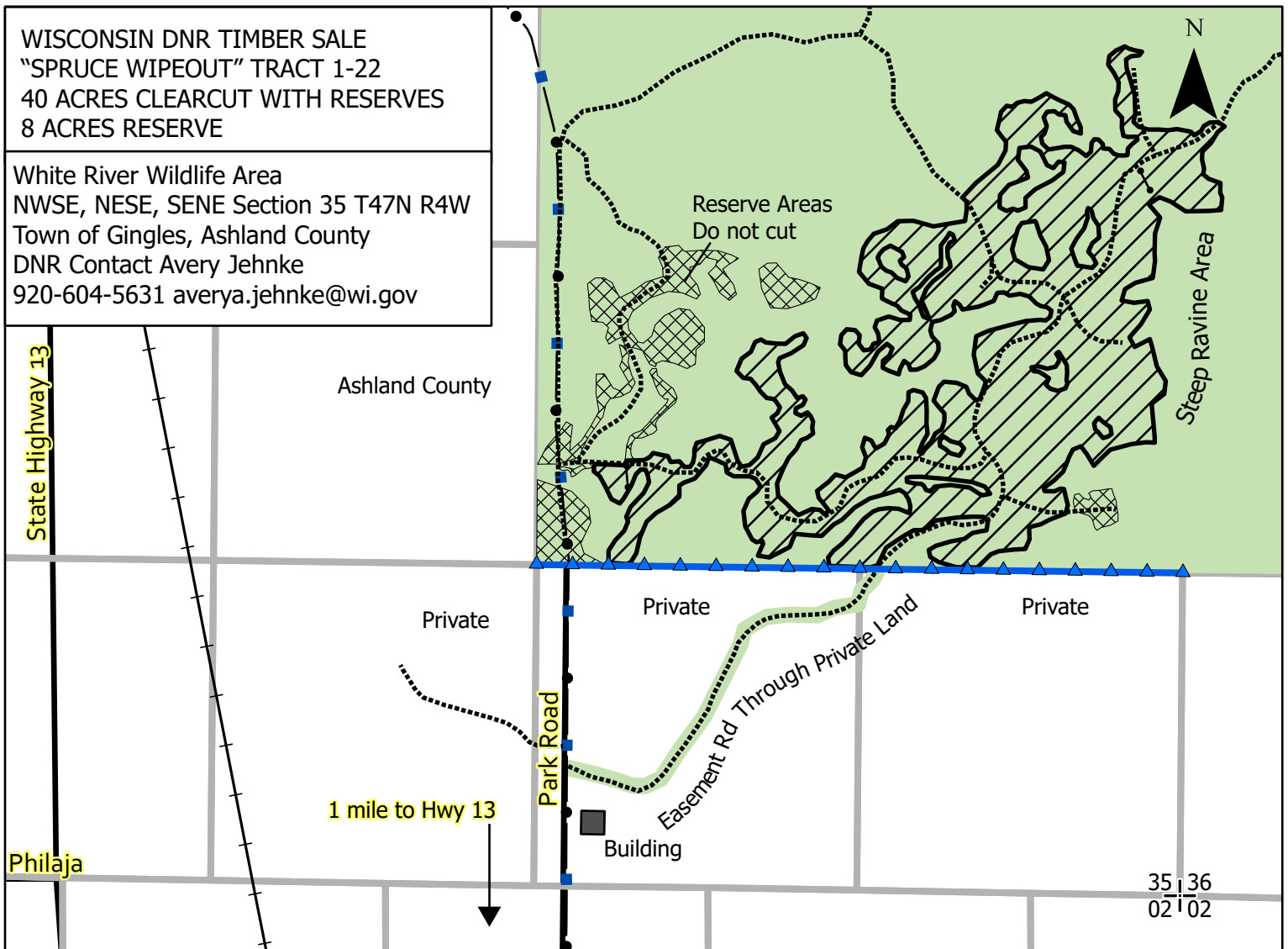

Map prepared April 2022 by A. Jehnke
 This map is not a survey of the actual
 boundary of any property it depicts.



0 0.07 0.15 0.3 Miles

1:7920
 1" = 1/8 Mile

General Sale Conditions:

- **Contract length is three years (3 winter seasons)**
- Ticket scale sale
- Sale boundaries marked with red paint or unmarked using natural boundaries
- Excessive rutting or damage to residual trees will result in suspension of logging activities
- Care must be taken to preserve all survey monuments
- Retain all suitable snag and den trees that do not pose a safety hazard
- Reserve all red marked boundary trees
- Utilize all trees to a 4-inch minimum top diameter
- Scatter all slash and cut to within 2 feet of the ground
- New roads, trails and landings must be approved by the sale administrator
- Equipment must be clean before entering sale area
- Snowmobile Trail must be kept clear and free of debris during harvesting and hauling operations
- Cautionary signage shall be posted on Park Road and snowmobile trail.

Cutting Specifications:

- Cut all trees greater than 1" DBH except designated reserve trees and trees marked with green paint.
 - Designated reserve trees are: Red Pine, White Pine, Cedar and Oak.
 - Aspen (4-6" DBH) at the edges of sale area should be left uncut.
- Harvesting and hauling will be limited to **FROZEN GROUND CONDITIONS ONLY.**

Estimated Volumes:

Species	Volume	Min. Price
SPRUCE	900 TONS	\$4/ton
ASPEN	500 TONS	\$9/ton
MIXED HARDWOOD	140 TONS	\$5/ton
TOTAL:	1,540 TONS	
Minimum Value:	\$8,800.00	

LEGEND

- ▶ Blue Paint Line
- Woods Roads
- ▨ Harvest Area
- ▩ Reserve- No Harvest
- Snowmobile Trails
- DNR Property
- +— Railroad
- + Section Corners
- 1/4 Section Lines
- Road
- ⌘ Gate