

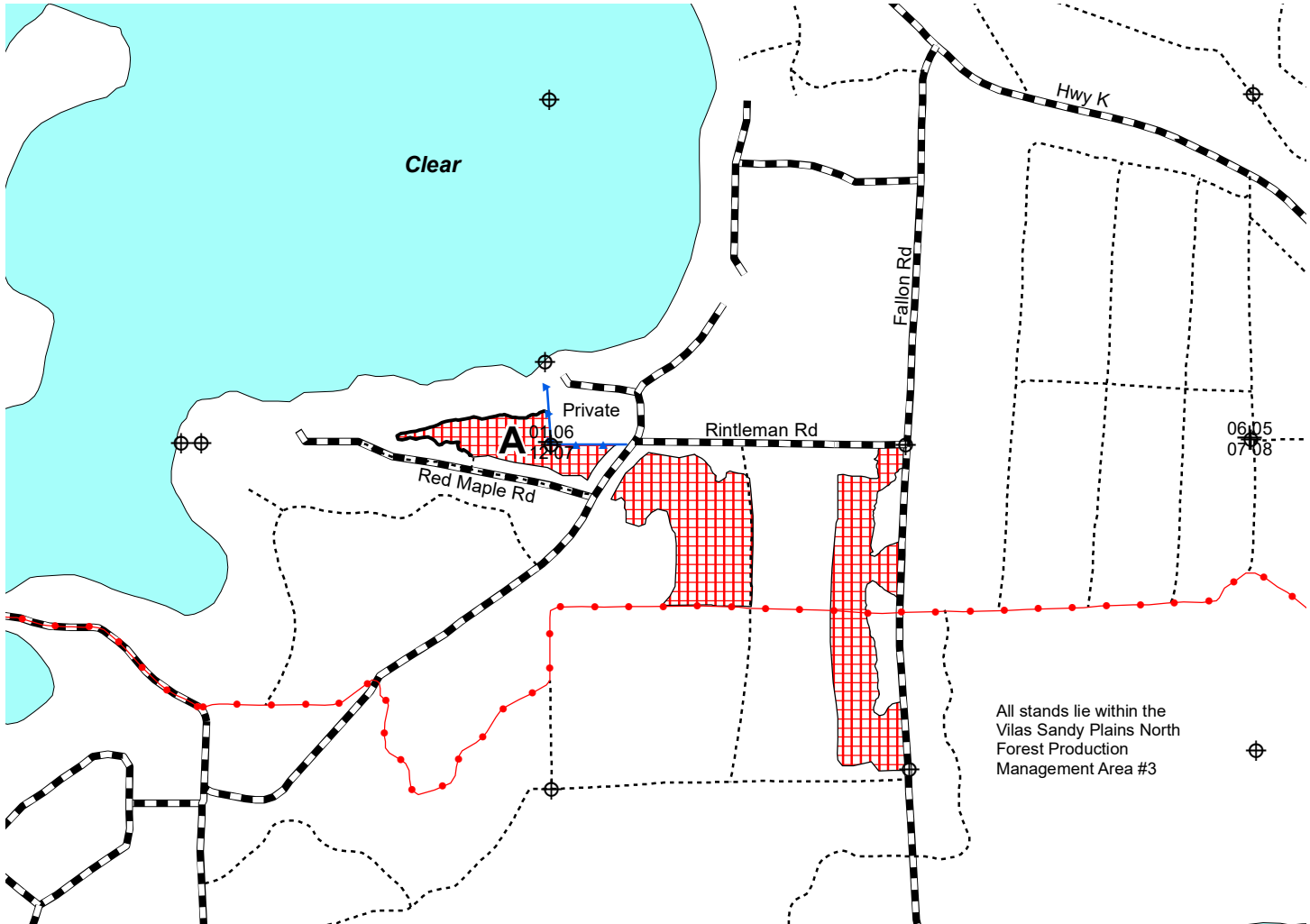







**WISCONSIN  
DEPARTMENT OF NATURAL RESOURCES  
TIMBER SALE  
TRACT 26-23 RED PINE BANE  
T42N R5E SECTIONS 1, 12  
T42N R6E SECTION 7  
HARVEST ACRES - 49**



All stands lie within the Vilas Sandy Plains North Forest Production Management Area #3

N  
Scale: 4" = 1 Mile  
1:15,840

**Legend**

-  Survey Marker
-  Section Corner
-  Blue Line
-  Red Line
-  Snowmobile Trails
-  Woods Roads
-  Highways and Town Roads
-  Lakes

 Red Pine First Thinning (49 Acres): Cut all trees marked with orange paint.

Zone A: Harvest activity only allowed between August 1 and January 14.



Map produced by  
Todd Anderson &  
Chase Christopherson, 08/23

This map is not a survey of the actual boundary of any property this map depicts.

NH-ALSF TRACT 26-23

Red Pine Bane

Vilas County

The cutting area is approximately 49 acres.

All trees that will yield one or more 100-inch sticks to the minimum top diameter chosen by the bidder will be cut and utilized.

Whole tree utilization is NOT allowed.

---

<u>SPECIES</u>	<u>ESTIMATED VOLUME (TONS)</u>
Red Pine <sup>1</sup>	<u>MINIMUM TOP DIAMETER</u> 4" 960
<b><u>Total Minimum Bid Value    \$ 5,376.00</u></b>	

---

<sup>1</sup> Contains approximately 87% red pine, 13% jack pine and less than 1% white pine. Volume includes approximately 4 MBF red pine.

Sale contains approximately 20 tons/acre or 9 cords/acre.

Special Conditions

1. SEASONAL RESTRICTION: Harvest activity allowed in the area labeled Zone A only between August 1 thru January 14.
2. All landings and any new roads must be approved prior to sale start up. All roads must be cleared of debris and leveled upon sale completion.
3. Treat all slash within 50 feet of the Town Roads to lie within 2 feet of the ground.
4. Do not cut, knock down or utilize any dead trees unless they pose an operational safety risk.
5. If the contract is to be worked on during multiple time periods a mid-contract "pull-off" inspection meeting will be required. One week notice shall be given by the contractor prior to moving equipment off-site. During the "pull-off" inspection, provisions needing attention will be documented. The contractor at that time can decide to remedy them before pulling equipment off or rectify them when moving back onto the site. If the latter is chosen, documented items shall be addressed before harvesting can continue.

**Notice:** Completion of this form is mandatory. The Department will not recognize your bid unless you complete and submit this form. Personal information collected will be used for program administration and may be provided to requesters as required by Wisconsin's Public Records law [ss. 19.31-19.39, Wis. Stats.].

Date

Bidder Name

Street Address	City	State	ZIP Code
----------------	------	-------	----------

Property Name (if any) NH-AL STATE FOREST	Timber Sale Name Red Pine Bane	Tract Number 26-23
--	-----------------------------------	-----------------------

Date and Hour of Bid Opening 1:30pm-November 15, 2023	Minimum Acceptable Bid (optional) \$5,376.00
--	---

Species-All bids including Lump Sum bids must be by species	Utilization Specifications (4 inch/Whole Tree/Logs)	Estimated Volume	Volume Units (tons/cords/mbf)	Price Bid Per Unit	Total Bid Value on Estimated Volume
Red Pine	4 inch	960	tons		

The award shall be based on this TOTAL BID AMOUNT:

**Performance Bond**

Will be in the form of: (select one)

- |  |   |
|--|---|
| <input type="radio"/> Personal Check               | <input type="radio"/> Assurance Bond                |
| <input type="radio"/> Certified Check/Money Order  | <input type="radio"/> Certificate of Deposit        |
| <input type="radio"/> Irrevocable Letter of Credit | <input type="radio"/> Assignment of Savings Account |

I understand that any or all bids may be rejected and that consideration and awarding of a contract will be based upon my past performance and ability to complete contracts. **I also understand that if I am the winning bidder, I have 6 weeks from the date of the bid opening to submit an acceptable performance bond. I also understand that if I am awarded the contract and fail to execute it or work under it, I will be required to forfeit to the Department an amount equal to 10% of my total bid amount.** Failure to forfeit the 10% penalty will result in being considered ineligible to bid on any state timber sales for a two-year duration. In the event the highest bidder can not or will not sign the contract, the award may be made to the next highest qualified bid.

By checking this box, I certify that I hold a Wisconsin Master Logger Certification.

**Notice:** I understand:

Utilization specifications and estimated volumes are listed in the prospectus which is available upon request from the Department.

A copy of the standard timber sales contract which must be entered into is available upon request from the Department.

Signature of Bidder
Bidder's Name (Please Print or Type)
Phone Number (include area code)
Email Address