

**WISCONSIN
DEPARTMENT OF NATURAL RESOURCES
TIMBER SALE
TRACT 03-23 BEAR CORN
T42N R7E SECTIONS 33, 34
HARVEST ACRES - 22**

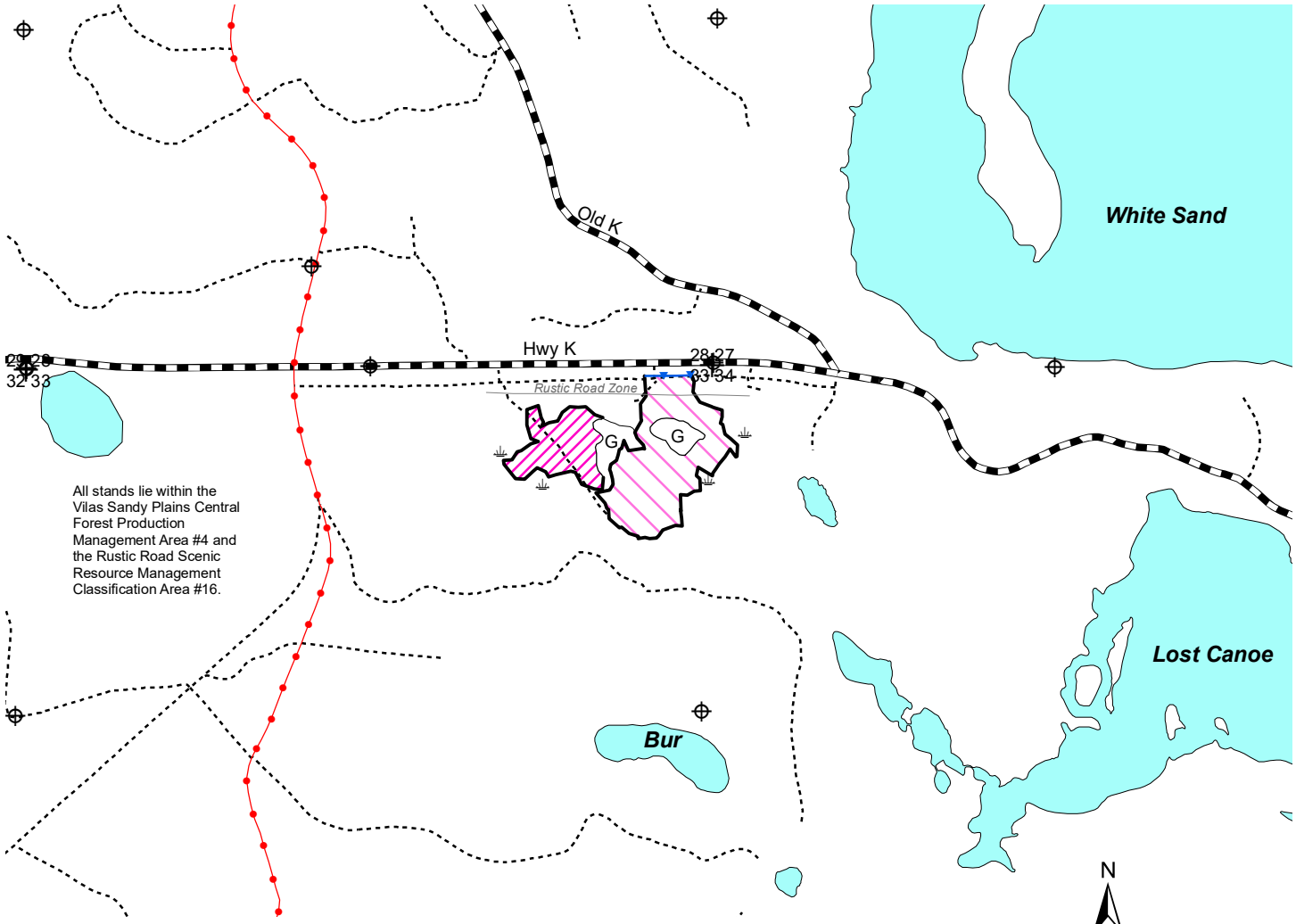

All stands lie within the Vilas Sandy Plains Central Forest Production Management Area #4 and the Rustic Road Scenic Resource Management Classification Area #16.

N
Scale: 4" = 1 Mile
1:15,840

Legend

- G Grassy Opening
- K Keg/Swamp
- ⊕ Survey Marker
- ⊕ Section Corner
- Blue Line
- Red Line
- Snowmobile Trails
- - - Woods Roads
- ▬ Highways and Town Roads
- ▭ Lakes

- Aspen/Pine (7 Acres): Cut all aspen, jack pine, maple, white birch and orange marked trees.
- Oak (15 Acres): Cut all aspen, jack pine, maple, oak, and white birch not marked green. Use caution to not damage white pine saplings.

Note: No harvesting or skidding April 15 - July 15 due to the risk of Oak Wilt.



Map produced by
Chase Christopherson, 02/23

This map is not a survey of the actual boundary of any property this map depicts.

NH-ALSF TRACT NO. 03-23

Bear Corn

Vilas County

Town 42 North, Range 7 East

Section 33 – NENE, NWNE

Section 34 – NWNW

15% of the total sale bid value will be required for performance bond.

The cutting area is approximately 22 acres.

The contract period is 2 years.

All trees that will yield one or more 100-inch sticks to the minimum top diameter will be cut and utilized.

Whole Tree harvest is not allowed.

ESTIMATED VOLUME (TONS)

MINIMUM TOP DIAMETER

<u>SPECIES</u>	<u>4"</u>
Red Pine ¹	40
Jack Pine	80
Aspen	180
Red Oak ²	775
Mixed Hardwood ³	45

TOTAL MINIMUM BID VALUE: \$ 14,941.50

1 Red Pine consists of 65% red pine and 35% white pine. Included is an estimated 7 MBF of sawlog material. Wt. Conv. 2.250 tons/cord.

2 Red Oak includes an estimated 38 MBF of sawlog material.

3 Mixed Hardwoods consists of 59% soft maple and 41% white birch. Wt. Conv. 2.400 tons/cord.

Note: Total sale volume equates to 50.9 tons/acre or 19.9 cords/acre.

Special Conditions:

1. No harvesting, skidding or road construction from April 15th to July 15th due to the risk of oak wilt.
2. Landings for forest products are not permitted within the rustic road management area which extends 233 feet from the centerline of Hwy K.
3. Cutting must be concurrent for all species to be harvested. Do not cut, knock down or utilize any dead trees.
4. All pine products cut between April 1 and September 1 must be removed from the sale area within three weeks from time of cutting. Pine products cut during the remainder of the year must be removed prior to April 1 of each year.
5. If the contract is to be worked on during multiple time periods a mid-contract "pull-off" inspection meeting will be required. One-week notice shall be given by the contractor prior to moving equipment off-site. During the "pull-off" inspection provisions needing attention will be documented. The contractor at this time can decide to remedy them before pulling off or rectify them when moving back onto the site. If the latter is chosen documented items shall be addressed before harvesting can continue.

Notice: Completion of this form is mandatory. The Department will not recognize your bid unless you complete and submit this form. Personal information collected will be used for program administration and may be provided to requesters as required by Wisconsin's Public Records law [ss. 19.31-19.39, Wis. Stats.].

Date

Bidder Name

Street Address	City	State	ZIP Code
----------------	------	-------	----------

Property Name (if any) Northern Highland - American Legion SF	Timber Sale Name Bear Corn	Tract Number 03-23
--	-------------------------------	-----------------------

Date and Hour of Bid Opening May 3, 2023 1:30 PM	Minimum Acceptable Bid (optional) \$14,941.50
---	--

Species-All bids including Lump Sum bids must be by species	Utilization Specifications (4 inch/Whole Tree/Logs)	Estimated Volume	Volume Units (tons/cords/mbf)	Price Bid Per Unit	Total Bid Value on Estimated Volume
Red Pine	4-inch	40	tons		
Jack Pine	4-inch	80	tons		
Aspen	4-inch	180	tons		
Red Oak	4-inch	775	tons		
Mixed Hardwood	4-inch	45	tons		

The award shall be based on this TOTAL BID AMOUNT:

Performance Bond Will be in the form of: (select one)

Personal Check
 Assurance Bond
 Certified Check/Money Order
 Certificate of Deposit
 Irrevocable Letter of Credit
 Assignment of Savings Account

I understand that any or all bids may be rejected and that consideration and awarding of a contract will be based upon my past performance and ability to complete contracts. **I also understand that if I am the winning bidder, I have 6 weeks from the date of the bid opening to submit an acceptable performance bond. I also understand that if I am awarded the contract and fail to execute it or work under it, I will be required to forfeit to the Department an amount equal to 10% of my total bid amount.** Failure to forfeit the 10% penalty will result in being considered ineligible to bid on any state timber sales for a two-year duration. In the event the highest bidder can not or will not sign the contract, the award may be made to the next highest qualified bid.

By checking this box, I certify that I hold a Wisconsin Master Logger Certification.

Notice: I understand:

Utilization specifications and estimated volumes are listed in the prospectus which is available upon request from the Department.

A copy of the standard timber sales contract which must be entered into is available upon request from the Department.

Signature of Bidder
Bidder's Name (Please Print or Type)
Phone Number (include area code)
Email Address