

**WISCONSIN
DEPARTMENT OF NATURAL RESOURCES
TIMBER SALE
TRACT 035-23W L and Abe
T36N R6E SECTIONS 9, 10, & 16
HARVEST ACRES - 65**

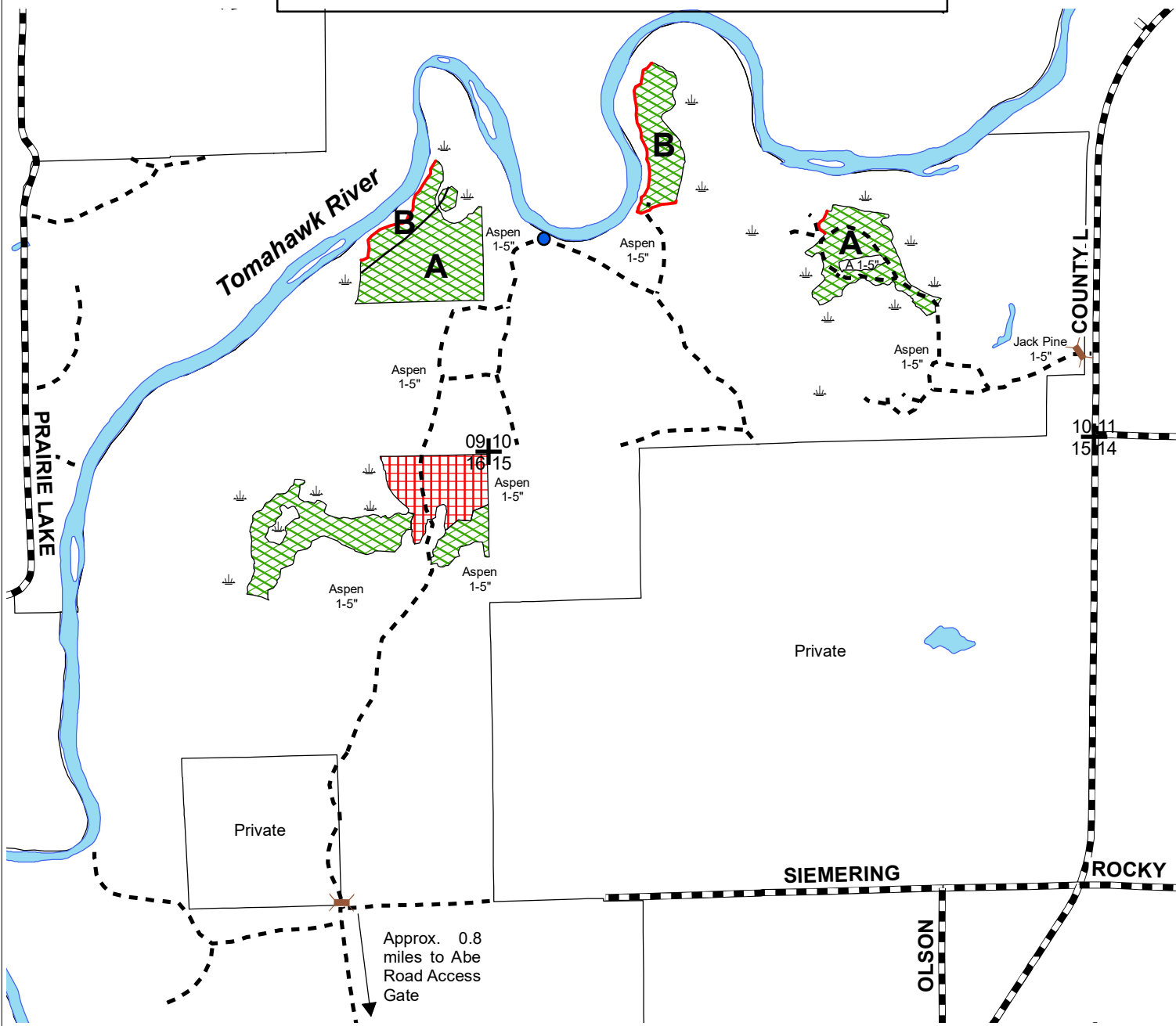

Legend

- Red Line
- Gates
- Culvert
- Section Corners
- Woods Roads
- Town/County Roads
- Lakes/Rivers
- Wetland



Aspen Area (54 acres): Cut all aspen, white birch, maple, balsam fir, jack pine, and orange marked trees. Cut all 1-5" aspen and maple concurrently. Do NOT cut any green marked trees.



Red Pine Thinning (11 acres): Cut same as above.

Zone A (26 acres): Logging operations can only occur from Sept. 16 - May 14.
Zone B (12 acres): Logging operations can only occur from Nov. 1 - March 14.
Zones A & B: Daylight working hours only.

This sale is located within the Forested Backlands Forest Production Area, Lower River Pines Native Community, and the River Scenic Management Area



4" = 1 mile
1:15,840



Map produced by
Adam Wallace, 10/22

This map is not a survey of the actual boundary of any property this map depicts.

WILLOW FLOWAGE TRACT NO. 035-23W

L and Abe

Oneida County

Town 36 North, Range 6 East (Nokomis Township)

Section 9 – NESE

Section 10 – NESW, SENW, W1/2SE

Section 16 – N1/2NE

No bid bond is required.

15% of the total sale bid value or \$1000.00, whichever is greater, will be required for performance bond.

The cutting area is approximately 65 acres.

The contract period is 3 years.

All trees that will yield one or more 100-inch sticks to a 4” top diameter will be cut and utilized.

Whole tree utilization or biomass harvesting is not allowed.

ESTIMATED VOLUME (TONS)
MINIMUM TOP DIAMETER

<u>SPECIES</u>	<u>4”</u>
Red Pine ¹	100
Jack Pine ²	330
Aspen	1650
Mixed Hardwood ³	290

Total Minimum Bid Value: \$21,419.00

¹ Approximately 74% red pine, 26% white pine. Includes 11 MBF red pine and 2 MBF white pine sawtimber. (Wt. conv. 2.250 tons/cd)

² Approximately 98% jack pine, 2% balsam fir (Wt. conv. 2.125 tons/cd)

³ Approximately 50% red maple, 49% white birch, 1% oak. (Wt. conv. 2.400 tons/cd)

Note: Total sale volume equates to 37 tons/acre or 16 cords/acre.

Special Conditions:

1. All pine products cut between April 1 and September 1 must be removed from the sale area within three weeks from time of cutting. Pine products cut during the remainder of the year must be removed prior to April 1 of each year.
2. Cutting must be concurrent for all species. Do not damage residual trees.
3. Do not cut, knock down or utilize any dead trees, except they may be cut down along roadways where they pose a safety hazard.
4. Slash within 50 feet of all roads, trails, and waterbodies must be lopped and/or scattered to lie within two feet of the ground and be pulled back 10’ behind the tree line concurrently with cutting. No slash allowed across any red lines, or within any wetland or waterbody.
5. Follow WI BMP’s for water quality at all times. Avoid wetlands as much as possible and only operate within them during very dry times with timber matting or under frozen ground conditions.
6. Landings and any new logging roads generally must be 200’ or greater from the Tomahawk River. Roads and landings must be approved by the Willow Flowage Property Manager in advance.
7. Logging operations in Zone A(approx. 26 acres) will only be allowed from September 16 to May 14. Logging operations in Zone B(approx. 12 acres) will only be allowed from November 1 to March 14. Logging operations must occur during daylight hours in Zones A & B to avoid disturbing nearby campers.
8. Logging access into the sale from Abe Road through private property has been verbally granted. This access road must remain in good drivable condition for passenger vehicles at all times. No access through the private property will be allowed during the gun deer season. Contact the Willow Flowage Property Manager in advance for access through the gates.

Notice: Completion of this form is mandatory. The Department will not recognize your bid unless you complete and submit this form. Personal information collected will be used for program administration and may be provided to requesters as required by Wisconsin's Public Records law [ss. 19.31-19.39, Wis. Stats.].

Date

Bidder Name

Street Address

City

State

ZIP Code

Property Name (if any)

Willow Flowage Scenic Waters Area

Timber Sale Name

L & Abe

Tract Number

035W

Date and Hour of Bid Opening

May 3, 2023 1:30pm

Minimum Acceptable Bid (optional)

\$21,419.00

Species-All bids including Lump Sum bids must be by species	Utilization Specifications (4 inch/Whole Tree/Logs)	Estimated Volume	Volume Units (tons/cords/mbf)	Price Bid Per Unit	Total Bid Value on Estimated Volume
red pine	4 inch	100			
jack pine	4 inch	330			
aspen	4 inch	1,650			
mixed hardwood	4 inch	290			

The award shall be based on this TOTAL BID AMOUNT:

Performance Bond

Will be in the form of: (select one)

Personal Check

Assurance Bond

Certified Check/Money Order

Certificate of Deposit

Irrevocable Letter of Credit

Assignment of Savings Account

I understand that any or all bids may be rejected and that consideration and awarding of a contract will be based upon my past performance and ability to complete contracts. **I also understand that if I am the winning bidder, I have 6 weeks from the date of the bid opening to submit an acceptable performance bond. I also understand that if I am awarded the contract and fail to execute it or work under it, I will be required to forfeit to the Department an amount equal to 10% of my total bid amount.** Failure to forfeit the 10% penalty will result in being considered ineligible to bid on any state timber sales for a two-year duration. In the event the highest bidder can not or will not sign the contract, the award may be made to the next highest qualified bid.

By checking this box, I certify that I hold a Wisconsin Master Logger Certification.

Notice: I understand:

Utilization specifications and estimated volumes are listed in the prospectus which is available upon request from the Department.

A copy of the standard timber sales contract which must be entered into is available upon request from the Department.

Signature of Bidder

Bidder's Name (Please Print or Type)

Phone Number (include area code)

Email Address