

**WISCONSIN
DEPARTMENT OF NATURAL RESOURCES
TIMBER SALE
TRACT 05-24 SEED ORCHARD
T38N R7E SECTIONS 9, 10
HARVEST ACRES - 63**

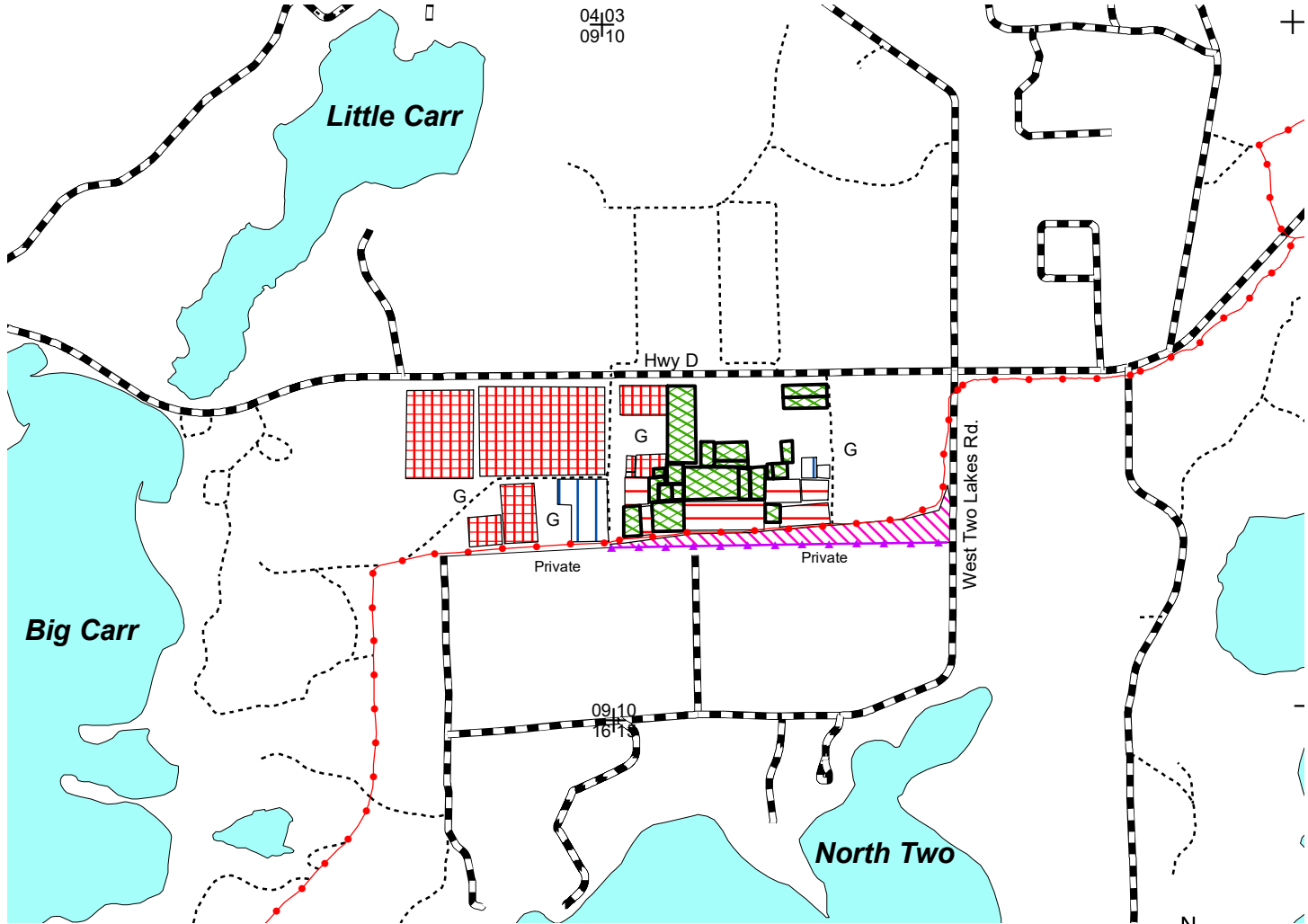

Scale: 4" = 1 Mile
1:15,840

Legend	
G	Grass
⊕	Survey Marker
+	Section Corner
—	Red Line
—	Purple Line
•—•	Snowmobile Trails
----	Woods Roads
▬▬▬	Highways and Town Roads
■	Lakes

- Select Removal (30 Acres): Cut blue marked trees.
- Clear Cut (14 Acres): Cut all trees including red marked boundary trees and all trees 1-5 inches in diameter.
- Row Thin (7 Acres): Cut blue marked rows. Rows run east and west.
- Row Thin (4 Acres): Cut blue marked rows. Rows run north and south.
- Oak Thinning (8 Acres): Cut all aspen, birch, maple and blue marked trees.

Note: Oak Thinning harvesting operations only allowed July 16 - April 14.



Map produced by
Chase Christopherson, 12/23

This map is not a survey of the actual boundary of any property this map depicts.

NH-ALSF TRACT 05-24
Seed Orchard

The cutting area is approximately 63 acres.

All trees that will yield one or more 100-inch sticks to the minimum 4" top diameter will be cut and utilized.

Contract expires 12/31/2026

ESTIMATED VOLUME (TONS)

MINIMUM TOP DIAMETER

<u>SPECIES</u>	<u>4"</u>
Red Pine ¹	400
Spruce ²	1650
Mixed Hardwood ³	310

Total Minimum Bid Value \$ 12,472.00

1 Red Pine Includes a potential 51 MBF of sawlog material.

2 Spruce consists of approximately 60% spruce (980 tons), 18% white pine (295 tons), 16% jack pine (270 tons), 4% tamarack (65 tons) and 2% balsam fir (40 tons). Included is a potential 57 MBF of sawlog material.

3 Mixed Hardwood consists of approximately 44% oak (135 tons), 27% aspen (85 tons) and 29% maple (90 tons). Included is an estimated 5 MBF of sawlog material.

Total sale volume equates to approximately 37.4 tons/acre or 17.5 cords/acre.

Special Conditions:

1. Harvesting operations in oak thinning stand allowed July 16th – April 14th.
2. Contractor must have harvester/operator participate in a pre-sale meeting and walk-through of sale area with DNR Forester prior to any harvesting activity. Several portions of the sale area require trees between the harvest blocks to be removed. One clear-cut block must have several mature balsam clumps retained.
3. Snowmobile trails must be kept free of debris and left in good condition for vehicle traffic at all times.
4. Cutting must be concurrent for all species to be harvested.
5. Biomass harvesting is not allowed.
6. No tops or slash allowed across any property line. Slash within 50 feet of the highways/town roads must be lopped and scattered within 2 feet of the ground and pulled back into the sale area at least 10 feet from the edges of those areas.
7. All pine products cut between April 1 and September 1 must be removed from the sale area within three weeks from the time of cutting. Pine products cut during the remainder of the year must be removed prior to April 1 of each year.
8. If the contract is to be worked on during multiple time periods a mid-contract "pull-off" inspection meeting will be required. One-week notice shall be given by the contractor prior to moving equipment off-site. During the "pull-off" inspection, provisions needing attention will be documented. The contractor at that time can decide to remedy them before pulling equipment off or rectify them when moving back onto the site. If the latter is chosen, documented items shall be addressed before harvesting can continue.

Notice: Completion of this form is mandatory. The Department will not recognize your bid unless you complete and submit this form. Personal information collected will be used for program administration and may be provided to requesters as required by Wisconsin's Public Records law [ss. 19.31-19.39, Wis. Stats.].

Date

Bidder Name

Street Address City State ZIP Code

Property Name (if any) Timber Sale Name Tract Number
NH-AL State Forest Seed Orchard 05-24

Date and Hour of Bid Opening Minimum Acceptable Bid (optional)
1:30 pm - January 10th, 2024 \$12,472.00

Species-All bids including Lump Sum bids must be by species	Utilization Specifications (4 inch/Whole Tree/Logs)	Estimated Volume	Volume Units (tons/cords/mbf)	Price Bid Per Unit	Total Bid Value on Estimated Volume
Red Pine	4 inch	400	tons		
Spruce	4 inch	1,650	tons		
Mixed Hardwood	4 inch	310	tons		

The award shall be based on this TOTAL BID AMOUNT:

Performance Bond Will be in the form of: (select one)

Personal Check
 Assurance Bond
 Certified Check/Money Order
 Certificate of Deposit
 Irrevocable Letter of Credit
 Assignment of Savings Account

I understand that any or all bids may be rejected and that consideration and awarding of a contract will be based upon my past performance and ability to complete contracts. **I also understand that if I am the winning bidder, I have 6 weeks from the date of the bid opening to submit an acceptable performance bond. I also understand that if I am awarded the contract and fail to execute it or work under it, I will be required to forfeit to the Department an amount equal to 10% of my total bid amount.** Failure to forfeit the 10% penalty will result in being considered ineligible to bid on any state timber sales for a two-year duration. In the event the highest bidder can not or will not sign the contract, the award may be made to the next highest qualified bid.

By checking this box, I certify that I hold a Wisconsin Master Logger Certification.

Notice: I understand:

Utilization specifications and estimated volumes are listed in the prospectus which is available upon request from the Department.

A copy of the standard timber sales contract which must be entered into is available upon request from the Department.

Signature of Bidder

Bidder's Name (Please Print or Type)

Phone Number (include area code)

Email Address
