

NH-ALSF TRACT 25-06
Old White Birch Sale

Vilas County

Town 41 North, Range 8 East

Section 5 – SWSW, SWSE, SESE

Section 8 – NENE, NWNE, NENW

Section 9 – NWNW

10% of the total sale bid value will be required as bid bond.

15% of the total sale bid value will be required for performance bond.

The cutting area is approximately 105 acres.

The contract period is 2 years.

All trees that will yield one or more 100-inch sticks to the minimum top diameter chosen by the bidder will be cut and utilized.

ESTIMATED VOLUME (CORDS)

MINIMUM TOP DIAMETER

<u>SPECIES</u>	<u>4"</u>	<u>Whole Tree</u>	<u>Advertised Price Per Unit</u>
Mixed Hardwood ¹	750		\$ 17.60
Red Pine ²	160		\$ 30.00
Balsam Fir ³	50		\$ 12.00

ESTIMATED VOLUME (MBF)

Hard Maple ⁴	40	\$ 170.00
Red Oak	160	\$ 212.50

¹Volume includes 54% maple, 45% red oak and 1% white birch and aspen

²Red pine is 15% sawlogs and 85% pulpwood

³Balsam fir volume is 90% fir and 10% white pine

⁴Hard maple sawlogs are 85% MH and 15% MS

Special Conditions:

1. No tops or slash allowed across any red line, blue line, or in any open swamp.⁽¹⁵⁾
2. All landings and any new woods roads must be approved prior to sale start up. Snowmobile trail must be kept free of debris and left in good condition for vehicle traffic at all times.⁽¹⁷⁾
3. No cutting of green marked trees and other trees marked red or blue.



**Wisconsin
Department of Natural Resources
Timber Sale
Tract 25-06 Old White Birch Sale
T41N 8E Sections 5, 8, 9
Harvest Area 105 Acres**

Scale
4" = 1 mile

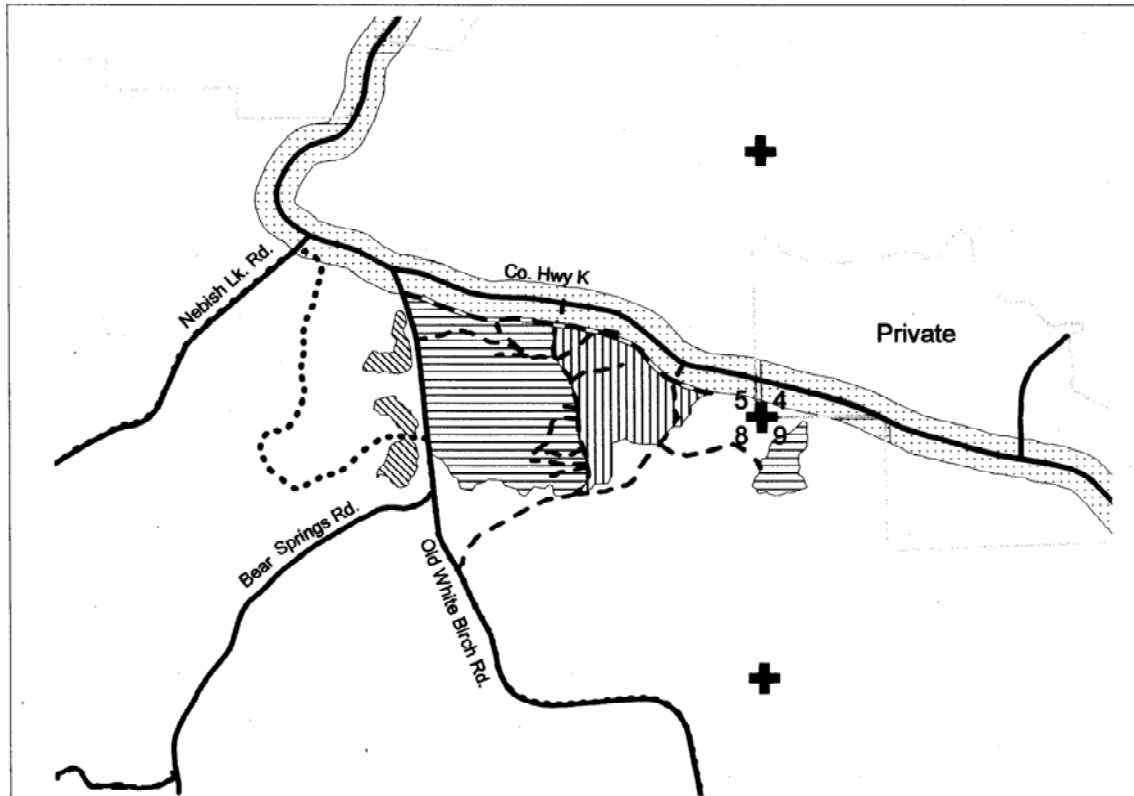

LEGEND	
	Red Line
	Blue Line
	Woods Roads
	Maintained Roads
	Snowmobile Trail
	Rustic Road Buffer
	Section Corner

- Red Pine Area (9 acres): Cut only those red pine marked with orange paint. Cut all merchantable size Balsam Fir.
- Oak Shelterwood Area (67 acres): Cut all trees except those marked with green paint. Also do not cut ANY Red and White Pine or Hemlock.
- Northern Hardwoods (29 acres): Cut all trees marked with orange. Designate cut Aspen, White Birch, Balsam Fir, and Ironwood. Do not cut ANY trees marked with green paint.