

NH-ALSF TRACT NO. 17-07
Boulder Flats Salvage

Vilas County
Town 42 North, Range 7 East
Section 20 – SENW, NWNW, NESW

This is a lump sum sale.

10% of the total sale bid value will be required as bid bond.

15% of the total sale bid value will be required for performance bond.

50% of the total sale bid value must be paid prior to cutting in Block “A”; and the remaining 50% must be paid prior to cutting in Block “B”

The cutting area is approximately 25 acres.

The contract period is 6 months.

All trees that will yield one or more 100-inch sticks to the minimum top diameter chosen by the bidder will be cut and utilized.

ESTIMATED VOLUME (CORDS)

MINIMUM TOP DIAMETER

<u>SPECIES</u>	<u>4”</u>	<u>Whole Tree</u>	<u>Advertised Price Per Unit</u>
Jack Pine ¹	520	--	\$ 23.70
Red Pine ²	85	--	\$ 34.00
Aspen ³	10	--	\$ 17.40

¹ Includes less than 1% balsam fir

² Approximately 40% sawlog volume

³ Volume contains 80% aspen and 20% other hardwoods

Special Conditions:

1. Each zone must be cut separately and Block “A” must be cut first.⁽¹³⁾
2. Cutting must be concurrent for all species to be harvested.⁽⁹⁾
3. All harvesting activities in sale area must be completed by June 30th 2008.⁽¹³⁾
4. No tops or slash allowed in keg area, or across any red or blue lines.⁽¹⁶⁾
5. All landings and any new woods roads must be approved by the forester prior to sale start up. Snowmobile trails must be kept free of debris, snow covered, and left in good condition for vehicle traffic at all times. Decking will be permitted along the snowmobile trail only when the trail is not in use. All wood decked on the snowmobile trail must be removed prior to the start of the next snow season. All trails must be restored to pre-harvest condition before the start of each snowmobile season.⁽¹⁸⁾
6. All pine products cut must be removed from the sale area within three weeks or by June 30th, 2008.⁽³⁵⁾

Lump Sum Contract Conditions:

1. Volume to be cut is estimated but not guaranteed. If the volume of timber exceeds the estimate, as a whole or by species, the Purchaser has the obligation to cut and remove it. If there is less timber than estimated, there is no obligation to the Seller to make up the deficiency. The timber designated or marked will not be changed to increase the cut to the estimate.
2. No portion of the stumpage payment will be returned to the Purchaser after award and signing of the Contract.
3. Forest products and stumpage remaining on the sale area at expiration of the Contract revert to ownership of the Seller. **June 30, 2008.**
4. Hauling on the same day from both this sale and a scaled timber sale located on land owned by the Seller, without authorization from the Seller, will be considered a breach and repudiation of this Contract by the Purchaser.
5. Other conditions:
 - A. Each zone must be cut separately and Block “A” must be cut first.
 - B. 50% of the total sale bid value must be paid prior to cutting in Block “A”; and the remaining 50% must be paid prior to cutting in Block “B”.
 - C. The contract period is 6 months.

**WISCONSIN
 DEPARTMENT OF NATURAL RESOURCES
 TIMBER SALE
 TRACT 17-07 BOULDER FLATS SALVAGE
 T42N R7E SECTION 20
 HARVEST ACRES - 25**

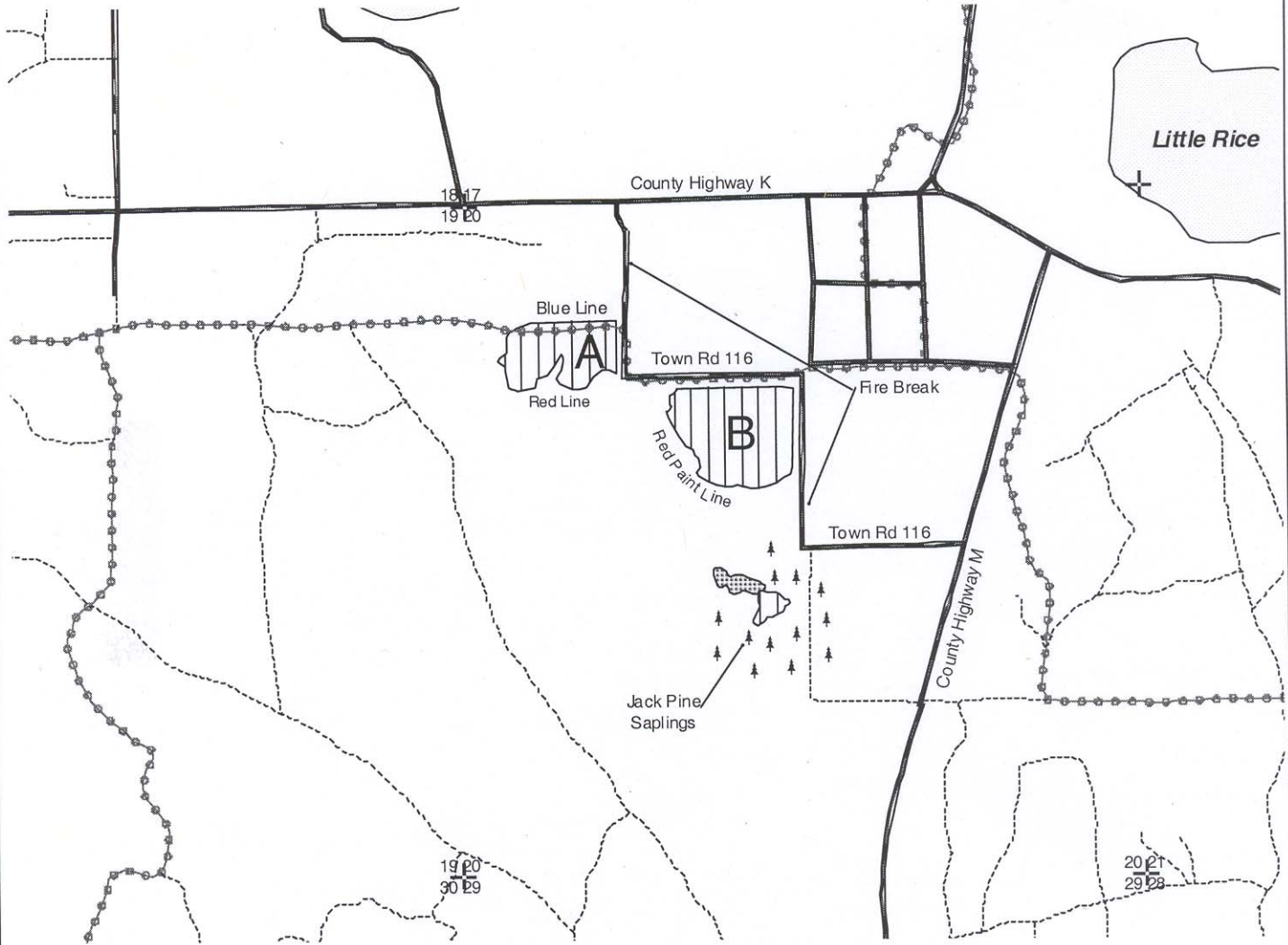

Legend

- Section Corner
- Woods Roads
- Highways and Town Roads
- Snowmobile Trails
- Lakes
- Keg
- Sale Area

Sale Area (25 Acres): Cut all trees except those marked with green paint.

Note: Each zone must be cut separately and Block A must be cut first. 50% of the total sale bid value must be paid prior to cutting in Block A, and the remaining 50% must be paid prior to cutting in Block B. Area must be harvested by June 30th, 2008.

N

Scale: 4" = 1 Mile
1:15,840

Map produced by
Derek Jochimsen and
Paul Schutz, 9/07