

NH-ALSF TRACT NO. 23-07
River Lane Red Pine

Vilas County

Town 42 North, Range 6 East
Section 24 – NWNW

10% of the total sale bid value will be required as bid bond.

15% of the total sale bid value will be required for performance bond.

The cutting area is approximately 18 acres.

The contract period is 1 year.

All trees that will yield one or more 100-inch sticks to the minimum top diameter chosen by the bidder will be cut and utilized.

ESTIMATED VOLUME (CORDS)

MINIMUM TOP DIAMETER

<u>SPECIES</u>	<u>4"</u>	<u>Whole Tree</u>	<u>Advertised Price Per Unit</u>
Red Pine ¹	230	250	\$ 30.60
Aspen ²	5	5	\$ 17.00

¹Approximately 95% red pine and 5% jack pine.

²Approximately 95% aspen and 5% white birch.

Special Conditions:

1. Cutting must be concurrent for all species to be harvested.(9)
2. Slash within 50' of Town and County roads must be lopped and/or scattered to lie within two feet of the ground and pulled back at least ten feet behind the tree line concurrently with cutting.(16)

**WISCONSIN
DEPARTMENT OF NATURAL RESOURCES
TIMBER SALE
TRACT 23-07 River Lane Red Pine
T42N R6E SECTION 24
HARVEST ACRES - 18**

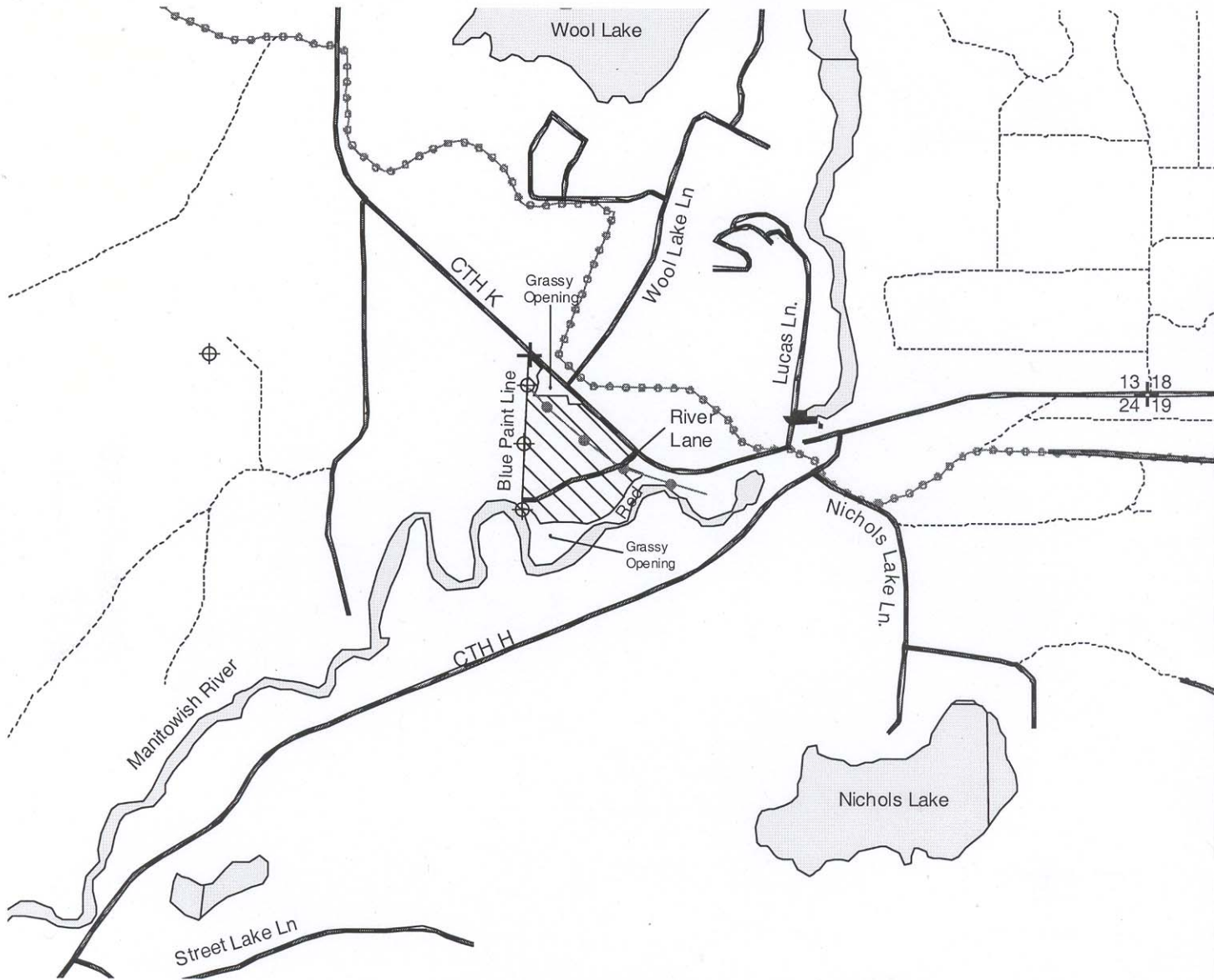

Legend

- ⊕ Survey Corners
- ⊕ Section Corners
- ⚓ Boat Landings
- Woods Roads
- == Town and County Roads
- Powerline
- Snowmobile Trails
- ▭ Lakes



Red Pine (18 Acres): Cut all aspen, white birch, jack pine and red pine marked with orange paint. Minimize damage to understory saplings when possible.

N
Scale: 4" = 1 Mile



Map produced by
Craig Dalton, 9/07