

NH-AL SF TRACT NO. 941-08
Harley Church Pines

Vilas County

Town 40 North, Range 6 East
Section 24 – NWSW

10% of the total sale bid value will be required as bid bond.
15% of the total sale bid value will be required for performance bond.
The cutting area is approximately 29 acres.
The contract period is 2 years.
All trees marked will be cut and utilized.

ESTIMATED VOLUME (CORDS)

MINIMUM TOP DIAMETER

<u>SPECIES</u>	<u>4"</u>	<u>Whole Tree</u>	<u>Advertised Price Per Unit</u>
Red Pine ¹	70	95	\$ 33.50

ESTIMATED VOLUME (MBF)

Red Pine ²	80		\$ 186.00
-----------------------	----	--	-----------

¹50% Red Pine, 50% White Pine.

²80% Red Pine, 20% White Pine.





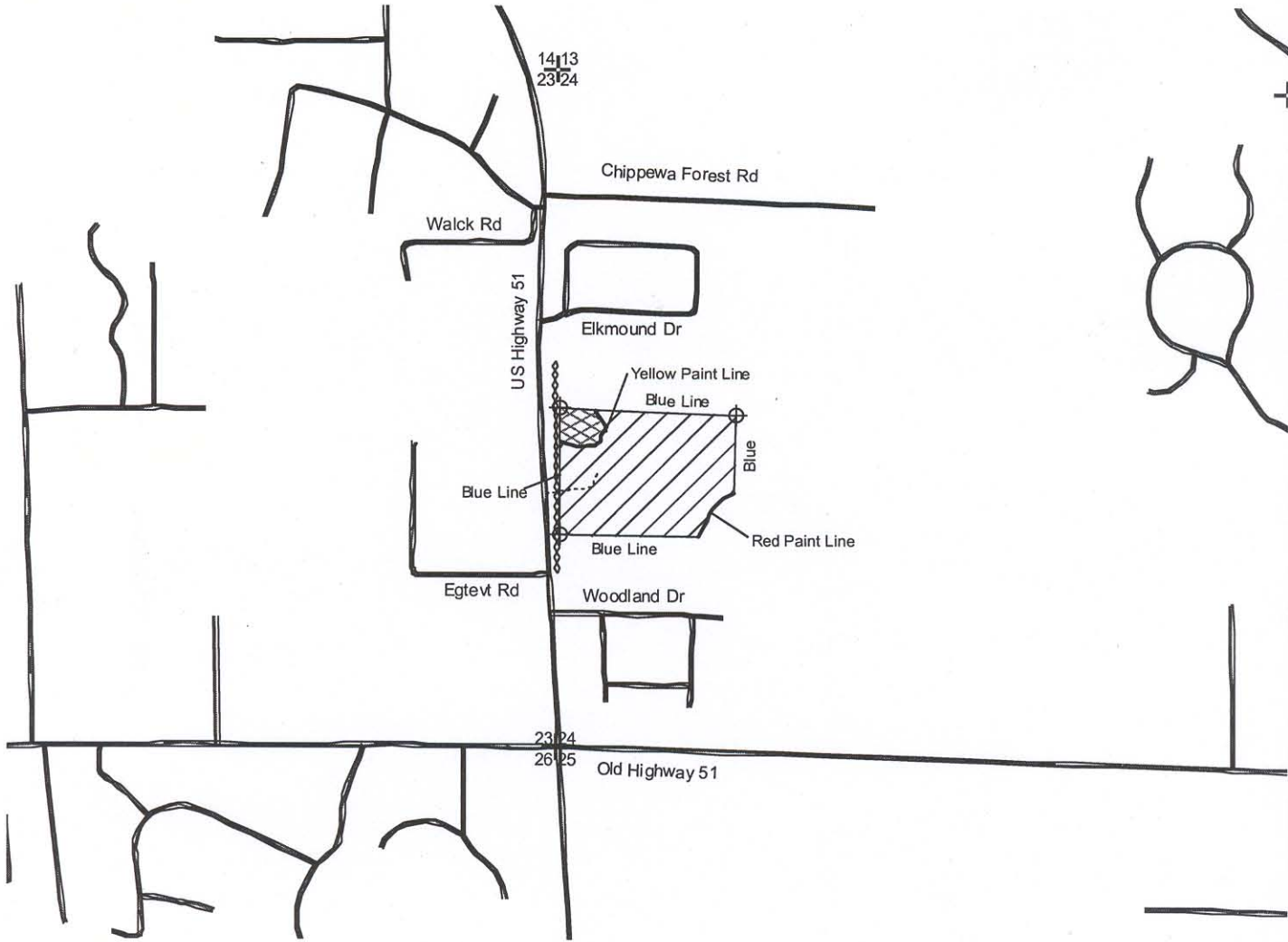

Special Conditions:



1. Cutting will occur on frozen or dry ground.
2. Meet with Forester before cutting begins.
3. All pine products cut between June 1 and September 1 each year must be removed from the sale area within three weeks from time of cutting. Pine products cut during the remainder of the year must be removed prior to June 1 of each year.
4. Slash will be kept to 2 foot or less lopped and scattered.

**WISCONSIN
DEPARTMENT OF NATURAL RESOURCES
TIMBER SALE
TRACT 941-08 HARLEY CHURCH PINES
T40N R6E SECTION 24
HARVEST ACRES - 29**



Legend

-  Section Corner
-  Iron Pipe
-  Woods Roads
-  Highways and Town Roads
-  Buried Utility Line
-  Pine Thinning Area
-  Clearcut Area

-  Pine Thinning Area (27 Acres): Cut all trees marked with orange paint.
-  Clearcut Area (2 Acres): Cut all trees, including all 1 to 5 inch trees..



Scale: 4" = 1 Mile
1:15,840



Map produced by
Kenneth Hayes and
Paul Schultz, 2.08