

SCATTERED STATE LANDS TRACT NO. 946-09

Compartment 3 Stands #1&2

Big Lake Sale

FSC Cert #SCS-FM/COC-00070N

Oneida County

Town 38 North, Range 11 East

Section 22 – Pt of GL 1, GL 2, NENE, NWNE, SWNE, SENE

10% of the total sale bid value will be required as bid bond.

15% of the total sale bid value will be required for performance bond.

The cutting area is approximately 106 acres.

The contract period is 2 years.

All trees that will yield one or more 100-inch sticks to the minimum top diameter chosen by the bidder will be cut and utilized.

ESTIMATED VOLUME (CORDS)

MINIMUM TOP DIAMETER

<u>SPECIES</u>	<u>4"</u>	<u>Whole Tree</u>	<u>Advertised Price Per Unit</u>
Mixed Hardwood ¹	1000	1370	\$ 21.40
Balsam Fir	100	125	\$ 11.90
Basswood ²	35	50	\$ 5.95
Aspen	15	20	\$ 23.80
Total Minimum Bid Value			\$ 23,155.25

¹Includes approximately 8 MBF of sawtimber

²Includes approximately 2 MBF of sawtimber

Special Conditions:

1. Cutting must be concurrent for all species to be harvested. No tree length or pole skidding allowed. No cutting will be permitted between April 1 and July 31.⁽⁹⁾
2. Slash must be lopped and scattered to lie within two feet of the ground. No tops or slash allowed across any blue line, or in any swamp.⁽¹⁶⁾
3. All landings and any new roads must be approved by the timber sale administrator. All roads must be repaired to original or better than original condition.⁽¹⁸⁾
4. All cutting to be done when the ground is frozen or dry. Leave all the standing dead trees that are not a safety hazard.⁽³⁵⁾

WISCONSIN
 DEPARTMENT OF NATURAL RESOURCES
BIG LAKE SALE
 TRACT #946-09
 T38N - R11E SECTION 22
 HARVEST AREA 106 ACRES



Map Created By:
 John Gillen 2/27/09

Scale 1" = 1/4 mile

Legend

	-----Aesthetic Area
	-----Marked Hardwood
BPL	-----Blue Paint Line
RPL	-----Red Paint Line
↑↑↑	-----Black Spruce Swamp
T	-----Tamarack Swamp
↓↓↓	-----Keg
H	-----Hemlock
•	-----Survey Pipe

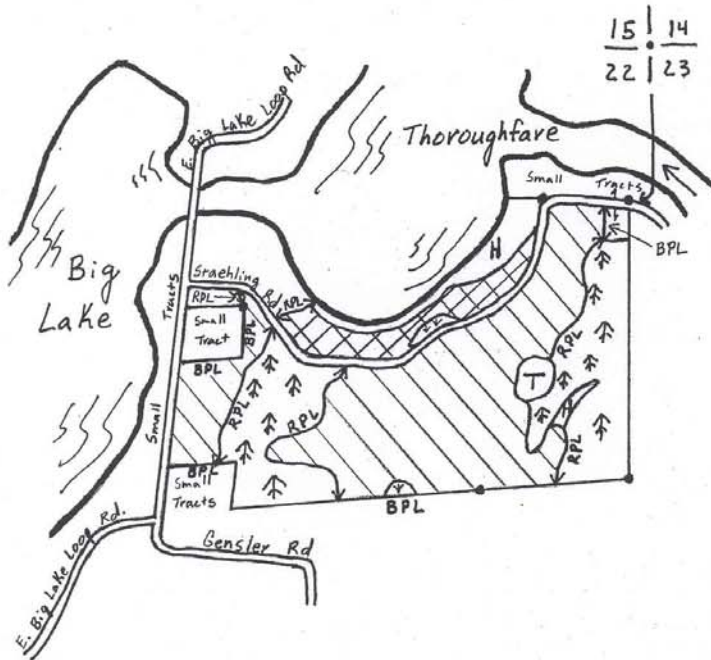

Marked Hardwood (97 acres):

1. Cut all merchantable aspen, white birch, balsam fir, and trees marked with orange paint.
2. **Do not cut** any aspen marked with green paint.
3. Within the **Yellow Circle Canopy Gaps**, cut all trees greater than 1 inch in diameter within the gaps, including all trees marked yellow.

Aesthetic Area (9 acres):

1. Cut all trees marked with orange paint and all balsam fir.
2. **Do not cut** any aspen or birch unless marked with orange paint.

*No cutting permitted between April 1 and July 31.

***Do not damage any hemlock** regeneration (especially in the aesthetic area).

*Take care not to damage maple regeneration.