

NH-ALSF TRACT NO. 12-07
Freedom

Vilas County

Town 41 North, Range 8 East
Section 8, 9 & 16

10% of the total sale bid value will be required as bid bond.

15% of the total sale bid value will be required for performance bond.

The cutting area is approximately 70 acres.

The contract period is 2 years.

All trees that will yield one or more 100-inch sticks to the minimum top diameter chosen by the bidder will be cut and utilized.

ESTIMATED VOLUME (CORDS)

MINIMUM TOP DIAMETER

<u>SPECIES</u>	<u>4"</u>	<u>Whole Tree</u>	<u>Advertised Price Per Unit</u>
Mixed Hardwood ¹	120	155	\$ 16.50
Jack Pine	510	650	\$ 29.90
Red Pine ²	350	440	\$ 40.10
White Pine ³	60	75	\$ 11.50

ESTIMATED VOLUME (MBF)

Red Oak	4	\$ 183.00
Mixed Hardwoods ⁴	5	\$ 125.00
White Pine	2	\$ 125.00

¹Includes 75% sugar maple, 10% red maple, and 15% red oak

²Includes red pine logs as a co-mingled product

³Includes 50% white pine and 50% balsam fir

⁴Includes 60% sugar maple, 39% red maple, and 1% white birch

Special Conditions:

1. Pole skidding WILL NOT be allowed within the marked Northern Hardwood area.⁽⁹⁾
2. No cutting will be permitted between April 1 and July 31 in the Northern Hardwood area.⁽¹³⁾
3. Cutting must be concurrent for all species to be harvested.⁽⁹⁾
4. Any landings or new roads must be approved by the forester prior to construction.⁽¹⁸⁾
5. Trees may not be felled into wetland/swamp areas.⁽¹⁶⁾
6. Decking will be permitted along the snowmobile trail only between April 1 and November 15. All wood must be removed by November 15.⁽¹⁸⁾
7. Snowmobile trails must be kept free of debris and left in good condition for vehicle traffic at all times.⁽¹⁸⁾
8. Snowmobile trails must be repaired to pre-harvest condition.⁽¹⁸⁾
9. All pine products cut between June 1 and September 1 must be removed from the sale area within three weeks from time of cutting. Pine products cut during the remainder of the year must be removed prior to June 1 of each year.⁽³⁵⁾

**WISCONSIN
DEPARTMENT OF NATURAL RESOURCES
TIMBER SALE
TRACT 12-07 FREEDOM
T41N R8E SECTIONS 8, 9 & 16
HARVEST ACRES - 70**

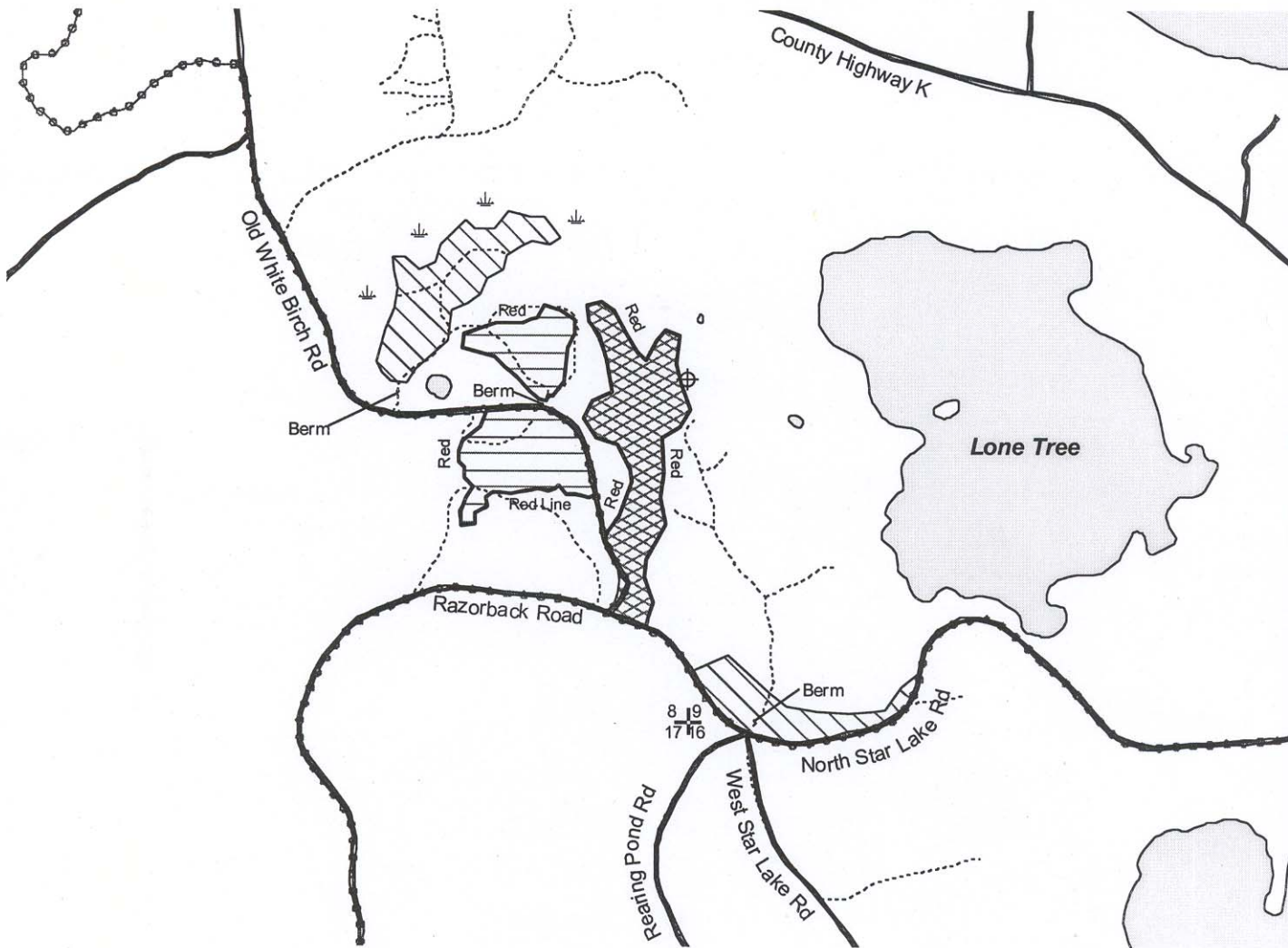

Legend

- Section Corner
- Iron Pipe
- Lowland Swamp
- Woods Roads
- Highways and Town Roads
- Snowmobile Trails
- Lakes
- Red/White Pine Area
- Northern Hardwood Area
- Jack Pine Area

- Red/White Pine Area (26 Acres): Cut all trees marked with orange paint.
- Northern Hardwood Area (22 Acres): Cut all trees marked with orange paint, including trees down to 2 inches. Cut all balsam fir with at least one merchantable stick.
- Jack Pine Area (22 Acres): Cut all trees, including all 1 to 5 inch trees.

N
Scale: 4" = 1 Mile
1:15,840

Map produced by
Kelly Oneil and
Paul Schultz, 9/07