

# CAVES CREEK FISHERY AREA

MARQUETTE COUNTY

See map legend for the activities allowed on the property or contact the DNR Service Center for more property information.  
PLEASE RESPECT LANDOWNERS' RIGHTS AND OBSERVE ALL PROPERTY POSTINGS.

For more information:  
PROPERTY MANAGER  
WAUTOMA SERVICE CENTER  
N2130 HIGHWAY 22 S  
WAUTOMA WI 54982-0400  
920-787-4686

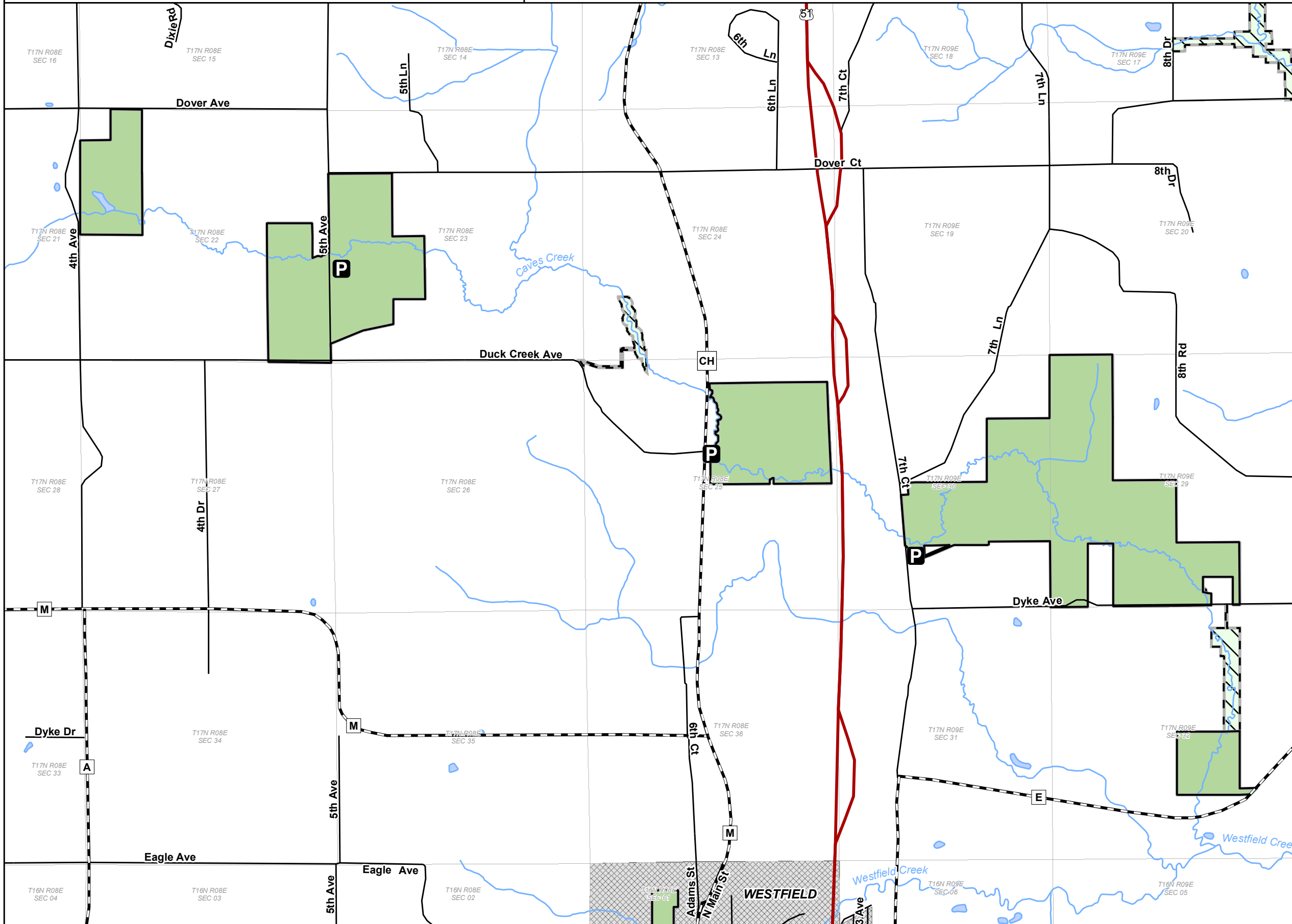

## DNR Managed Land

Open DNR Fishery Land

Other DNR Land

## Easement Use

Hunting and Fishing

Fishing Only

Hunting Only

Open, No Hunting or Fishing

Seasonally Closed

State Trail

Parking Area

Boat Access

Section Boundary

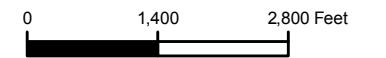

5280 feet = 1 mile



The data shown on this map have been obtained from various sources, and are of varying age, reliability and resolution. This map is not intended to be used for navigation, nor is this map an authoritative source of information about legal land ownership or public access. Users of this map should confirm the ownership of land through other means in order to avoid trespassing. No warranty, expressed or implied, is made regarding accuracy, applicability for a particular use, completeness, or legality of the information depicted on this map.

Wisconsin Department of Natural Resources



Featured property funded in part by  
Knowles-Nelson Stewardship Fund

FM-520 acr

Last revision date: Jul 15, 2009

[http://dnr.wi.gov/org/land/facilities/dnr\\_land\\_mapping.html](http://dnr.wi.gov/org/land/facilities/dnr_land_mapping.html)