

BEULAH STATION WILDLIFE AREA

WALWORTH COUNTY

See map legend for the activities allowed on the property or contact the DNR Service Center for more property information or additional public hunting areas. PLEASE RESPECT LANDOWNERS' RIGHTS AND OBSERVE ALL PROPERTY POSTINGS.

For more information:
PROPERTY MANAGER
C/O WAUKESHA
141 NW BARSTOW ST, ROOM 180
WAUKESHA, WI 53188
Phone: 262-574-2116

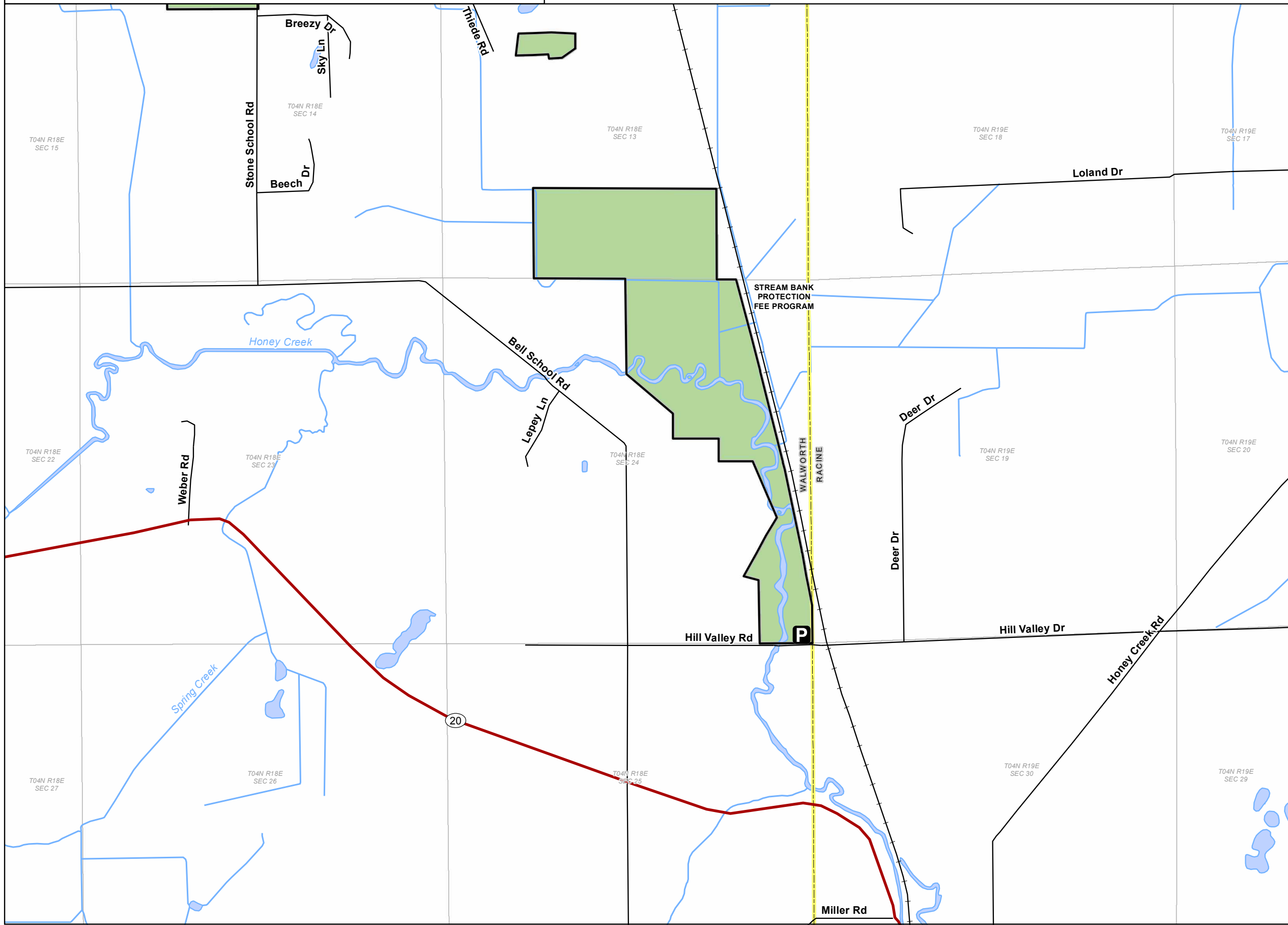

DNR Managed Land

- Open DNR Land
- Other DNR Land *may be restricted*

Easement Use

- Hunting and Fishing
- Fishing Only
- Hunting Only
- Open, No Hunting or Fishing

- State Trail
- Parking Area
- Boat Access
- Seasonally Closed

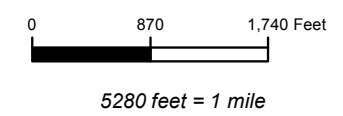

The data shown on this map have been obtained from various sources, and are of varying age, reliability and resolution. This map is not intended to be used for navigation, nor is this map an authoritative source of information about legal land ownership or public access. Users of this map should confirm the ownership of land through other means in order to avoid trespassing. No warranty, expressed or implied, is made regarding accuracy, applicability for a particular use, completeness, or legality of the information depicted on this map.

Wisconsin Department of Natural Resources



Featured property funded in part by
Knowles-Nelson Stewardship Fund
WM-5806 acr

Map last updated: May 31, 2011

http://dnr.wi.gov/org/land/facilities/dnr_land_mapping.html